

# DENTALEZ *HERITAGE*

## 2024

### *EMBRACING OUR TRADITION*

DENTALEZ has been providing high-quality equipment to the dental industry for over 60 years. The DENTALEZ Heritage product line continues the legacy of DENTALEZ equipment in a dedicated online catalog while supplies last. The future of DENTALEZ equipment will be re-imagined through the lens of the Forest equipment portfolio.



[DENTALEZ.COM/HERITAGE](https://dentalez.com/heritage)

Contact your local representative for more information.

DENTALEZ *HERITAGE*

# Operatory Packages



# Operator Packages

Since 1958, DentalEZ® Equipment has been at the forefront of developing simple, easy to use products that make work easier and more comfortable for dentists, hygienists and patients. Now we are making it easier to order DentalEZ Equipment with the operator equipment packages shown on the following pages.

Our NuSimplicity™ Chair has been the choice of dental chairs for large DSOs, Institutions and Government, as well as individual dentists. The simple design, coupled with superior height adjustment range and lift capacity sets this chair apart. With a proven track record of success with our largest customers, NuSimplicity is the choice when you want to combine power with simplicity.

The DentalEZ equipment tradition continued with our CORE™ Operatory Equipment. Designed to be easy to use, simple to adjust, and with all of the features you would expect, CORE provides everything you need at a price that makes the choice easy. When you think DentalEZ Equipment, think the Power of Simplicity.



# CORE™ Magellan Package

## CORE Chair

- Simple adjustments put patient in the ideal position
- Quiet, dependable and smooth operation
- Double articulating headrest
- Tapered back
- Fully hydraulic, four programmable positions (1 touchpad standard)

## CORE Delivery Unit

- 3 automatic handpiece positions with 3-way syringe
  - 4th handpiece position available
- Brake release handle
- Easy access control block and standard components for quick maintenance
- Built standard with BioFree Tubing

## Simplicity™ LED Light

- Smooth rotation and 3 axis adjustment allow for a wide range of light positioning to better view the oral cavity.



### NOTES:

Image shown contains optional handpieces and upgraded features:  
 Unit Touchpad Control 3655-362  
 4th Handpiece Position 3680-428  
 Star ETorque Electric System 3680-441

## Standard Package Ordering Information

Part Number	Description	Retail
3706-284PT	CORE Chair ( <i>seamed upholstery with 6 color options</i> )	\$9,014
3655-358	CORE Magellan Delivery Unit	\$5,618
3544-234	Simplicity LED	\$3,176
3625-817	Light Post	\$646
3625-936	Contoured USC	N/C
3554-202	Simplicity Operator Stool	\$809
3554-203	Simplicity Assistant Stool	\$1,234

**TOTAL: \$20,497**

# Popular Options



Delivery Unit  
Touchpad Control  
#3655-362



CORE L/R Assistant's  
Instrumentation with  
Touchpad  
#3625-931



Wired foot control  
#3613-127



Generation Assistant Stool with  
body support and backrest  
#3554-199



Generation Operator Stool  
#3554-198

## Popular Options Ordering Information

Part Number	Description	Retail
3625-923	Seamed Standard Upholstery in Non-Standard Color	\$956
3625-924	Designer Seamed Premium Ultraleather Upholstery in Non Standard Color	\$1,181
3625-926	Seamless upholstery	\$961
3613-127	Wired Foot Control	\$520
3625-931	CORE L/R Assistant Instrumentation with TouchPad	\$1,286
3625-899X1	Single 6-pin FO System <i>(includes power supply &amp; handpiece tubing)</i>	\$935
3655-362	Touchpad for CORE Magellan Unit	\$693
3680-428	4th Handpiece Control	\$628
3625-536	Additional HVE and Tubing	\$152
3680-437	Water Outlet with Flow Control and Air Quick Disconnect	\$278
3554-198	Generation Operator Stool	\$1,286
3554-199	Generation Assistant Stool	\$1,397
3951-238x	Credit for No Touchpad	-\$95



# CORE CMU Package

## CORE Chair

- Simple adjustments put patient in the ideal position
- Quiet, dependable and smooth operation
- Double articulating headrest
- Tapered back
- Fully hydraulic, four programmable positions (1 touchpad standard)

## CORE Delivery Unit

- 3 automatic handpiece positions with 3-way syringe
  - 4th handpiece position available
- Brake release handle
- Easy access control block and standard components for quick maintenance
- Built standard with BioFree Tubing

## Simplicity™ LED Light

- Smooth rotation and 3 axis adjustment allow for a wide range of light positioning to better view the oral cavity.



### NOTES:

Image shown contains optional handpieces and upgraded features: Galaxy Cuspidor (3709-058), Simplicity Telescoping Assistant Instrumentation (3501-426), Unit Touchpad (3655-360), Wired Foot Control (3613-127)

## Standard Package Ordering Information

Part Number	Description	Retail
3706-284	CORE Chair, 115V ( <i>seamed upholstery with 6 color options</i> )	\$8,421
3655-357	CORE Console Mounted Delivery Unit	\$7,256
3709-052x	Simplicity Cuspidor with Fixed Asst Instrumentation	\$2,326
3544-234	Simplicity LED	\$3,176
3625-710	Simplicity LED Light Post	\$247
3625-937	Contoured USC	N/C
3554-202	Simplicity Operator Stool	\$714
3554-203	Simplicity Assistant Stool	\$1,139

**TOTAL: \$23,279**

# Popular Options



Delivery Unit  
Touchpad Control  
#3655-360



Wired foot control  
#3613-127



Generation Assistant Stool with  
body support and backrest  
#3554-199



Generation Operator Stool  
#3554-198

## Popular Options Ordering Information

Part Number	Description	Retail
3625-923	Seamed Standard Upholstery in Non-Standard Color	\$956
3625-924	Designer Seamed Premium Ultraleather Upholstery in Non Standard Color	\$1,181
3625-926	Seamless upholstery	\$961
3613-127	Wired Foot Control	\$520
3709-058	Galaxy Cuspidor	\$3,008
3655-360	Touchpad for CORE Console Mounted Unit	\$693
3680-428	4th Handpiece Control	\$628
3625-536	Additional HVE and Tubing	\$152
3658-391	Water Quick Disconnect with Flow Control	\$130
3680-A69	Air Quick Disconnect	\$116
3625-899X1	Single 6-pin FO System <i>(includes power supply &amp; handpiece tubing)</i>	\$935
3501-426	Simplicity Telescoping Assistant Arm Package	\$761
3554-198	Generation Operator Stool	\$1,192
3554-199	Generation Assistant Stool	\$1,397
3951-238x	Credit for No Touchpad	-\$95

# NuSimplicity™ Magellan Package

## NuSimplicity Chair

- Integrated touchpads located on both sides of upper backrest
- Flip down armrests for easy patient entry and exit
- Thin, tapered back
- Wide range of height adjustments for maximum flexibility
- Choice of 4 Headrest options

## Galaxy Delivery Unit

- BioFree tubing on all internal water lines and handpiece tubings
- Die cast aluminum pinch valve system providing years of reliable performance
- 3 automatic handpiece positions with 3 way syringe
  - 4th handpiece position available
  - 5th position available for auxiliary products

## Simplicity™ LED Light

- Smooth rotation and 3 axis adjustment allow for a wide range of light positioning to better view the oral cavity.



### NOTES:

Image shown contains optional handpieces and upgraded plush upholstery with memory foam.

## Standard Package Ordering Information

Part Number	Description	Retail
3706-273	NuSimplicity Chair	\$9,618
3655-314G	Galaxy L/R Delivery Unit	\$8,579
3544-234	Simplicity LED	\$3,176
3625-817	Light Post	\$646
3625-836	Contoured USC	N/C
3554-202	Simplicity Operator Stool	\$714
3554-203	Simplicity Assistant Stool	\$1,139

**TOTAL: \$23,872**



# Popular Options



Delivery Unit  
Touchpad Control  
#3655-321



Galaxy L/R Assistant's  
Instrumentation  
#3625-830



Generation Assistant Stool with  
body support and backrest  
#3554-199



Generation Operator Stool  
#3554-198

## Popular Options Ordering Information

Part Number	Description	Retail
3706-275	NuSimplicity Chair with Air Glide	\$10,253
3625-912A	Designer Seamed Ultraleather Premium Upholstery (no memory foam)	\$1,176
3625-830	Galaxy L/R Assistant's Instrumentation	\$2,321
3625-899X1	Single 6-pin FO System (includes power supply & handpiece tubing)	\$935
3655-321	Touchpad for Galaxy Console Magellan Unit	\$478
3680-428	4th Handpiece Control	\$628
3625-536	Additional HVE and Tubing	\$152
3680-417	Water Outlet with Flow Control and Air Quick Disconnect	\$394
3554-198	Generation Operator Stool	\$1,192
3554-199	Generation Assistant Stool	\$1,397

# NuSimplicity CMU Package

## NuSimplicity Chair

- Integrated touchpads located on both sides of upper backrest
- Flip down armrests for easy patient entry and exit
- Thin, tapered back
- Wide range of height adjustments for maximum flexibility
- Choice of 4 headrest options

## Galaxy Delivery Unit

- BioFree tubing on all internal water lines and handpiece tubings
- Die cast aluminum pinch valve system providing years of reliable performance
- 3 automatic handpiece positions with 3-way syringe
  - 4th handpiece position available
  - 5th position available for auxiliary products

## Simplicity™ LED Light

- Smooth rotation and 3 axis adjustment allow for a wide range of light positioning to better view the oral cavity.



**NOTES:**  
Image shown contains optional handpieces.

## Standard Package Ordering Information

Part Number	Description	Retail
3706-273	NuSimplicity Chair	\$9,618
3655-313G	Galaxy Console Mounted Delivery Unit	\$10,159
3709-058	Galaxy Cuspidor	\$3,008
3501-426	Simplicity Telescoping Assistant Arm Package	\$761
3544-234	Simplicity LED	\$3,176
3625-710	Light Post	\$247
3951-304	Contoured USC	N/C
3554-202	Simplicity Operator Stool	\$714
3554-203	Simplicity Assistant Stool	\$1,139

**TOTAL: \$28,822**

# Popular Options



Delivery Unit  
Touchpad Control  
#3655-316



Generation Assistant Stool with  
body support and backrest  
#3554-199



Generation Operator Stool  
#3554-198

## Popular Options Ordering Information

Part Number	Description	Retail
3706-275	NuSimplicity Chair with Air Glide	\$10,253
3625-912A	Designer Seamed Ultraleather Premium Upholstery	\$1,176
3625-858	Wired Foot Control	\$1,061
3655-316	Touchpad for Galaxy for Console Mounted Delivery Unit	\$478
3680-338	4th Handpiece Control	\$593
3625-536	Additional HVE and Tubing	\$152
3658-391	Water Quick Disconnect with Flow Control	\$130
3680-A69	Air Quick Disconnect	\$116
3625-899X1	Single 6-pin FO System <i>(includes power supply &amp; handpiece tubing)</i>	\$935
3554-198	Generation Operator Stool	\$1,192
3554-199	Generation Assistant Stool	\$1,397

DENTALEZ *HERITAGE*

# Dental Stools & Chairs



# NuSimplicity™ Chair



Minimize twisting and reaching with an ergonomic design that provides easy access to the oral cavity. The NuSimplicity Chair is simple to use, technology-friendly, and makes positioning easy with its height flexibility.

Chair Options	Part Number	Retail
NuSimplicity Chair, 115V, Standard with dual touchpads	3706-273	\$9,618
NuSimplicity Chair with Air Glide, 115V, Standard with dual touchpads	3706-275	\$10,253

Upholstery Style Options <small>(see page 26 for color options)</small>	Part Number	Retail
Seamless Standard Upholstery	3625-823	N/C
Seamed Standard Upholstery	3625-824	N/C
Designer Seamed Ultraleather Premium Upholstery <i>(upgrade)</i>	3625-912A	\$1,176
Plush with Memory Foam Ultraleather Premium Upholstery <i>(upgrade)</i>	3625-825	\$1,292
Upholstered Armrest <i>(armrest same color as chair upholstery)</i>	3680-414	\$588
Special Color Upcharge	2796-005	\$331



Seamed



Seamless



Plush with Memory Foam



Designer Seamed



# NuSimplicity Chair continued



## Headrest Options

	Part Number	Retail
Double Articulating	3625-898	N/C
Premium Double Articulating	3625-525	N/C
Magnetic Catchers Mitt	3561-097	N/C



Double articulating



Premium double articulating



Magnetic catchers mitt

## Control Options

	Part Number	Retail
Wired Foot Control	3625-858	\$1,061



Touch Pad Controls  
standard on both  
sides of chair



Wired foot control

## Other Options

	Part Number	Retail
2" Hub Chair Adaptor*	3625-813	\$740
Light Receptacle Cord, 115V	3625-843	\$121
Basic USB Cable Option ( <i>no power</i> )	3680-411	\$78
Cable with Powered USB / Surge Protector	3951-308	\$247
Basic USB Cable with 33' Active Extension / Repeater Cable	3951-309	\$247

**NOTES:** \*No charge for chair adaptors if ordering a DentalEZ Delivery Unit.  
All Chairs available in 220V upon request.

# NuSimplicity Chair continued



Oral Surgery Options	Part Number	Retail
NuSimplicity Strap 22" <i>(one strap-black)</i>	3802-512	\$103
NuSimplicity Strap 54" <i>(one strap-black)</i>	3802-513	\$149
NuSimplicity Strap 80" <i>(one strap-black)</i>	3802-514	\$173
NuSimplicity Oral Surgery Chair Kit <i>(Integrated dual rails, one IV arm)</i>	3680-410	\$1,822
<b>SECOND ARM OPTIONS</b>		
Second IV Arm	3625-964	\$1,376
Bar Style Arm <i>(in lieu of second IV arm)</i>	3625-965	\$803
NuSimplicity IV Bag Stand	3625-812	\$625



NuSimplicity Oral Surgery Chair Accessories *(shown with optional IV bag stand)*



NuSimplicity Oral Surgery Arm



NuSimplicity Bar Style Arm option

Other Options	Part Number	Retail
2" Hub Chair Adaptor*	3625-813	\$740
Light Receptacle, 115V	3625-843	\$121
Basic USB Cable Option <i>(no power)</i>	3680-411	\$78
Cable with Powered USB / Surge Protector	3951-308	\$247
Basic USB Cable with 33' Active Extension / Repeater Cable	3951-309	\$247

**NOTES:** \*No charge for chair adaptors if ordering a DentalEZ Delivery Unit.  
All Chairs available in 220V upon request.

# NuSimplicity Specifications

## Specify

- Color choices listed on page 26
- Refer to the DentalEZ Upholstery Ring for samples
- Contact DentalEZ Customer Service for special materials and required yardage at 866-DTE-INFO

## Electrical Requirements

- 15 AMP Branch Circuit
- 115 VAC, 60 Hz, Single Phase
- 220 VAC, 50 Hz, Models Available

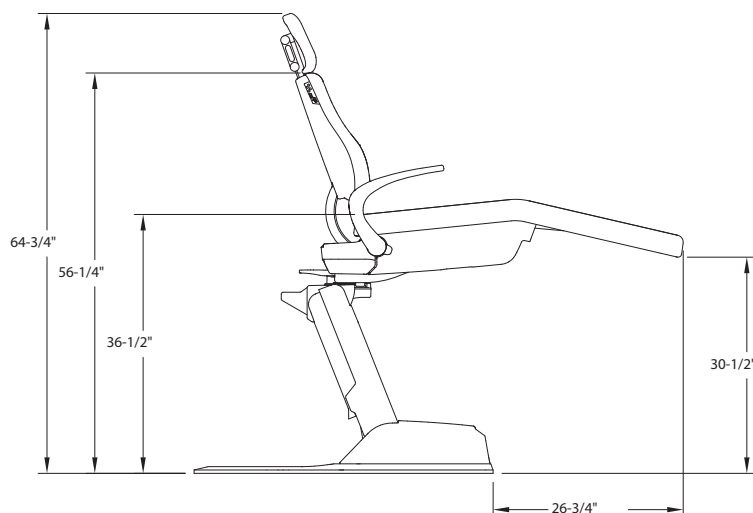
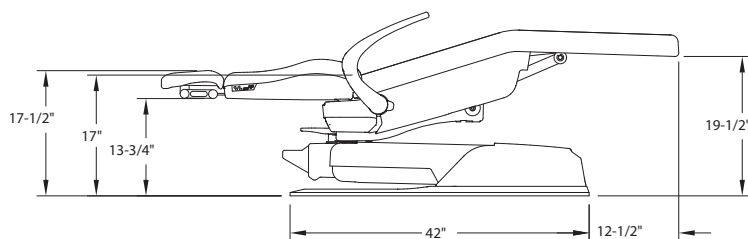
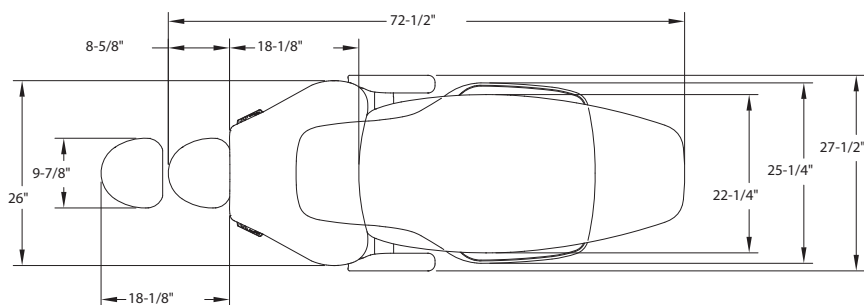

# CORE™ Chair



The CORE Chair situates patients in an ideal position with a durable hydraulic lift cylinder. The chair is quiet yet powerful with smooth operation.

	Part Number	Retail
CORE Chair, Standard with Touchpad and Double Articulating Headrest	3706-284	\$8,421
CORE Chair, Standard with Touchpad and Double Articulating Headrest, Pretubed	3706-284PT	\$9,014
Seamed Standard Upholstery (Standard colors are black, cocoa, deep sapphire, saddle, sand, taupe)	3625-922	N/C
Credit for No Touchpad	3951-238x	-\$95



Double articulating headrest (Standard)



## Upholstery Upgrade Options

	Part Number	Retail
Seamed Standard Upholstery in Non-standard Color	3625-923	\$956
Seamless Standard Upholstery for CORE Chair	3625-926	\$961
Designer Seamed UltraLeather Premium Upholstery without Memory Foam	3625-924	\$1,181
Special Color Upcharge	2796-005	\$331

## Chair Options

	Part Number	Retail
CORE Wired Foot Control	3613-127	\$520
Additional CORE Touchpad	3625-752X	\$525



Touchpad Control



Wired foot control

# CORE™ Chair Specifications

## Specify

- Color choices listed on page 26
- Refer to the DentalEZ Upholstery Ring for samples
- Contact DentalEZ Customer Service for required yardage at 866-DTE-INFO

## Electrical Requirements

- 115 VAC, 50/60 Hz, as applicable
- 220 VAC, 50/60 Hz, as applicable

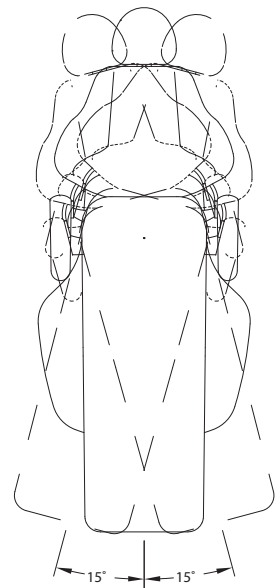
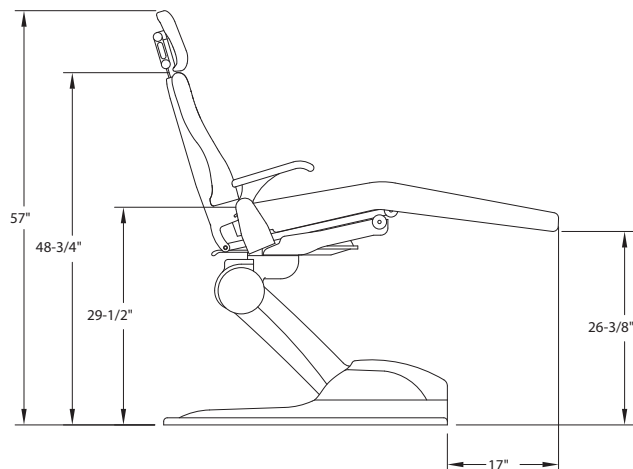
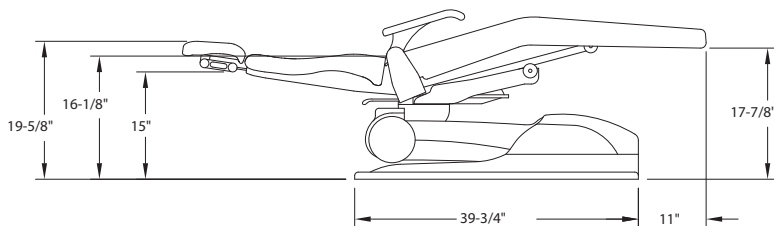
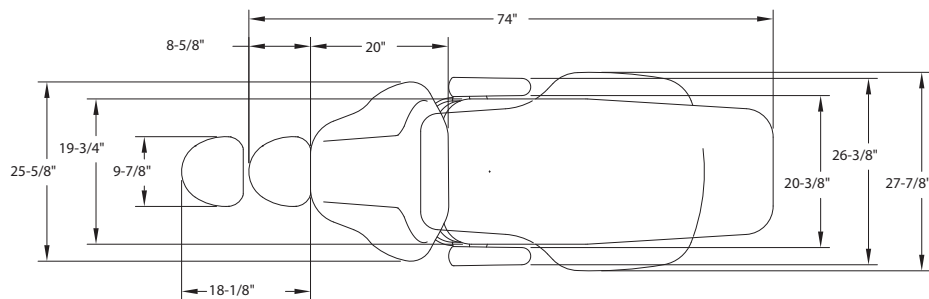



# Operator Stools



Position yourself properly for any procedure. Minimize stress and strain with operator and assistant stools from DentalEZ Equipment.



Generation



Simplicity

## Operator Stools

### Generation™

Operator Stool, 23" to 30.5"

Part Number

3554-198

Retail

\$1,192

Operator Stool with Ultraeather Premium Upholstery, 23" to 30.5"

3554-198U

\$1,286

### Simplicity™

Operator Stool, 21.5" to 29"

3554-202

\$714

Operator Stool with Ultraeather Premium Upholstery, 21.5" to 29"

3554-202U

\$809

## Elbow Supports

The DentalEZ Free-Motion Elbow Support attaches to any stool cylinder and supports the elbow of the dental professional.

Set of 2 Black Free Motion Elbow Supports

3625-775BL

\$1,029

One Black Free Motion Elbow Support

3625-774BL

\$520

## Operator Stool Options

Round Seat (*in lieu of contoured*)

3614-122

N/C

Tall Cylinder Stool Option (*in lieu of standard*), 1.5" to 3.5" taller than standard

3686-015

N/C

Short Cylinder Stool Option (*in lieu of standard*), 6.5" to 9" shorter than standard

3686-014

N/C

Special Color Charge

2796-003

\$158

# Assistant Stools



Simplicity with  
body support



Generation with body  
support and backrest

## Assistant Stools\*

Generation™	Part Number	Retail
Assistant Stool with Body Support, 24.5" to 34"	3554-199	\$1,397
Assistant Stool with Body Support & Ultraleather Premium Upholstery, 24.5" to 34"	3554-199U	\$1,481
Assistant Stool with Backrest	3554-200	\$1,260
Assistant Stool with Backrest & Ultraleather Premium Upholstery	3554-200U	\$1,344
Assistant Stool with Backrest & Body Support	3554-201	\$1,565
Assistant Stool with Backrest & Body Support & Ultraleather Premium Upholstery	3554-201U	\$1,654
Simplicity™		
Assistant Stool with Body Support, 23" to 32.5"	3554-203	\$1,139
Assistant Stool with Body Support & Ultraleather Premium Upholstery, 23" to 32.5"	3554-203U	\$1,234

## Elbow Supports

The DentalEZ Free-Motion Elbow Support attaches to any stool cylinder and supports the elbow of the dental professional.

Set of 2 Black Free Motion Elbow Supports	3625-775BL	\$1,029
One Black Free Motion Elbow Support	3625-774BL	\$520

Assistant Stool Options	Part Number	Retail
Round Seat <i>(in lieu of contoured)</i>	3614-122	N/C
Short Cylinder Stool Option <i>(in lieu of standard)</i> , 1.5" to 3.5" shorter than standard	3686-017	N/C
Extra Short Cylinder Stool Option <i>(in lieu of standard)</i> , 8" to 12.5" shorter than standard	3686-018	N/C
Special Color Charge	2796-003	\$158

**NOTES:** \*All assistant stools come standard with left-handed body support for working with right-handed dentists. Specify right-handed body support if needed for working with left-handed dentists.

# Stools Specifications

## Specify

- Color choices listed on page 26
- Refer to the DentalEZ Upholstery Rings for samples
- Left or right hand operator
- Contact DentalEZ Customer Service for special materials and required yardage at 866-DTE-INFO

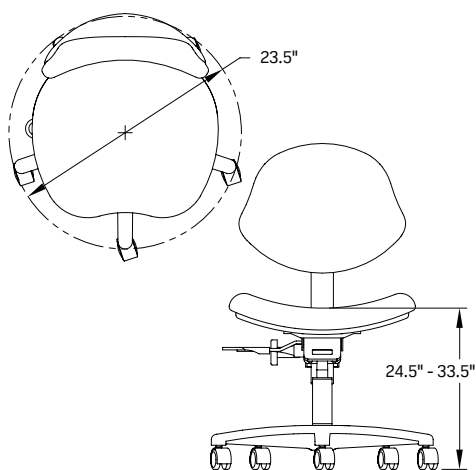

Generation Operator Stool

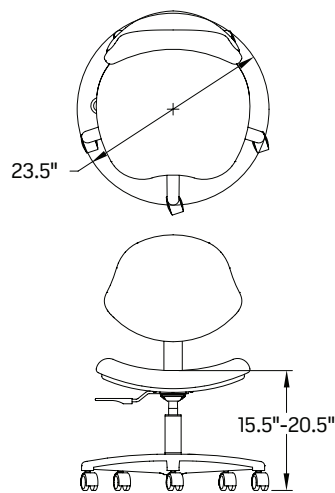

Simplicity Operator Stool

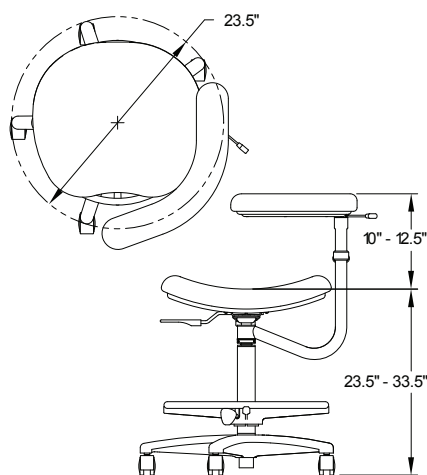

Generation Assistant Stool

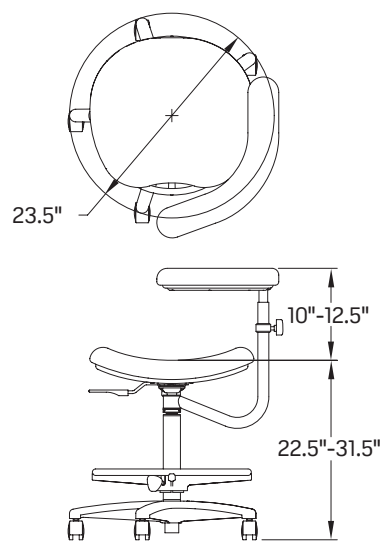

Simplicity Assistant Stool

## CORE™ Standard Upholstery Collection



Black  
US-393



Cocoa  
PR-51



Deep Sapphire  
PR-55



Saddle  
PR-52



Sand  
US-384



Taupe  
US-410

## Standard Upholstery Collection



Alabaster  
US-396



Ash  
DU-162



Black  
US-393



Dusty Jade  
US-417



Espresso  
US-383



Chestnut  
US-375



Tomato  
US-358



Port  
NEO-62



Golden Corn  
US-524



Sand  
US-384



Slate Blue  
NEO-26



Taupe  
US-410



Cocoa  
PR-51



Cream  
PR-44



Deep Sapphire  
PR-55



Feather  
PR-37



Harness  
PR-38



Ivy  
PR-53



Lake Louise  
PR-50



Mint Leaf  
PR-45



Saddle  
PR-52



Velvet Brown  
PR-43

## Premium Ultraleather Upholstery Collection



Autumn Leaf  
291-8233



Baltic  
291-2551

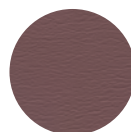

Boysenberry  
291-7214



Charcoal  
291-5763



Diplomat Blue  
291-2478



Doe  
291-3601



Dove Grey  
291-5666



Papyrus  
291-1256



Parrot  
291-4460



Raven Wing  
291-5607

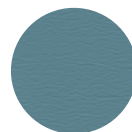

St. John  
291-2507



Stone  
291-3602



Pearlized Midnight  
322-2691

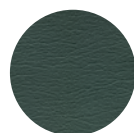

Pearlized Oz  
322-4304

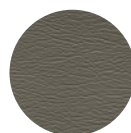

Pearlized Pewter  
322-5768



Pearlized Pharaoh  
322-6558

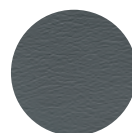

Pearlized Tin Man  
322-5976

### NOTES:

Colors shown may not match upholstery exactly; please request upholstery samples for exact colors.

DENTALEZ *HERITAGE*

# Delivery Units





# Delivery Units



Creating a new level of efficiency, DentalEZ Delivery Units provide the dentist flexibility in the ideal delivery unit for their practice.

## Delivery Unit Mounting Options

**Fixed Mount CMU**  
NuSimplicity™ Chair, Galaxy®  
head CMU with Assistant's  
Instrumentation, & Cuspidor



**Magellan Mount (Left/Right)**  
CORE Chair with CORE Magellan Unit &  
Assistant's Instrumentation



# Fixed Mount



## Delivery Head Options

	Part Number	Retail
CORE™	3655-357	\$7,256
Galaxy®	3655-313G	\$10,159



CORE Style



Galaxy Traditional Style

## Cuspidor and Assistant's Instrumentation Options

	Part Number	Retail
Simplicity Cuspidor	3709-051	\$2,258
Galaxy Cuspidor	3709-058	\$3,008
Simplicity Cuspidor with Fixed Assistant's Instrumentation	3709-052x	\$2,326
Simplicity Telescoping Assistant's Arm Package	3501-426	\$761



Simplicity Telescoping  
Assistant's Instrumentation



Simplicity Cuspidor with Fixed  
Assistant's Instrumentation



Galaxy Cuspidor

# Unit Options



UTILITY SERVICE CENTERS	Part Number	Retail
Basic USC	3951-235	\$557
NuSimplicity Contoured USC	3951-304	N/C
CORE Contoured USC	3625-937	N/C
Flush Mount USC <i>(in lieu of contoured USC)</i>	3625-597	\$866
CHAIR ADAPTORS		
CORE Chair Adaptor	3625-921A	N/C
No Chair Adaptor Supplied	3625-314	-( \$219)
POSTS		
Light Post <i>(for Simplicity and Simplicity LED Lights)</i>	3625-710	\$247
Light/Monitor Post <i>(for Simplicity and Simplicity LED Lights)</i>	3625-748	\$247
Monitor Post <i>(no light)</i>	3625-622	\$265
LCD Monitor Mount	3625-615	\$1,423
FIBER OPTIC CONTROLS	Part Number	
StarBright® Single FO System (includes power supply & handpiece tubings)	3625-899X1	\$935
StarBright Dual FO System (includes power supply & handpiece tubings)	3625-899X2	\$1,381
StarBright Triple FO System (includes power supply & handpiece tubings)	3625-899X3	\$1,832
TOUCHPAD OPTIONS		
Touchpad Option for CORE Console Mounted Delivery Unit <i>(for CORE Chair)</i>	3655-360	\$693
Touchpad Option for CORE Console Mounted Delivery Unit <i>(for NuSimplicity Chair)</i>	3655-361	\$693
Touchpad Option for Galaxy Console Mounted Delivery Unit <i>(for NuSimplicity Chair)</i>	3655-316	\$478
Touchpad Option for Galaxy Console <i>(for CORE Chair)</i>	3655-372	\$478
HANDPIECE CONTROL OPTIONS		
4th Handpiece Control <i>(for CORE Delivery Unit)</i>	3680-428	\$628
4th Handpiece Control <i>(for Galaxy Delivery Unit)</i>	3680-338	\$593

Fixed Mount Options continue on next page →

# Fixed Mount Options Continued

INTEGRATED PRODUCTS*	CORE	Galaxy
Integrated StarETorque	3680-441 \$6,143	3680-438 \$6,143

Power supply sold separately.

POWER SUPPLIES	Part Number	Retail
36V Power Supply	3625-762	\$709

ACCESSORIES		
Water Quick Disconnect with Flow Control <i>(Fixed Console Unit only)</i>	3658-391	\$130
Air Quick Disconnect <i>(Fixed Console Unit only)</i>	3680-A69	\$116
Additional HVE valve and tubing	3625-536	\$152
City Water Kit for CMU Units with cuspidors	3658-455PI	\$98
City Water Kit, Simplicity CMU	3658-456PI	\$457
Extra Length Umbilical <i>(specify number of feet not to exceed 10')</i>	3592-109-X	\$67 per ft.
Swivel Tray <i>(for Galaxy Head)</i>	3625-703	\$315

**NOTES:** \*These integrated products must be included when ordering any delivery system, they cannot be field installed.  
\*\*Tips are not included.

# Magellan Mount (Left/Right)



## Delivery Head Options *(touchpads available under options)*

	Part Number	Retail
CORE™	3655-358	\$5,618
Galaxy®	3655-314G	\$8,579



CORE Style  
*(with optional Touchpads  
and handpieces)*



Galaxy Traditional Style  
*(with optional Touchpads,  
handpieces and Curing light)*

## Cuspidor and Assistant's Instrumentation Options

FOR CORE CHAIR	Part Number	Retail
CORE L/R Assistant's Instrumentation with Touchpad	3625-931	\$1,286
CORE L/R Assistant's Instrumentation without Touchpad	3625-929	\$1,082
FOR NUSIMPLICITY CHAIR		
CORE L/R Assistant's Instrumentation without Touchpad	3625-929	\$1,082
CORE L/R Assistant's Instrumentation with Touchpad	3625-933	\$1,286
Simplicity L/R Assistant's Instrumentation without Touchpad	3625-828	\$2,095
Simplicity L/R Cuspidor	3625-839	\$3,785
Simplicity L/R Cuspidor with Assistant's Instrumentation	3625-840	\$3,917
Galaxy L/R Assistant's Instrumentation	3625-830	\$2,321
Galaxy L/R Cuspidor	3625-841	\$4,767



CORE L/R Assistant's  
Instrumentation with  
Touchpad



Galaxy L/R Assistant's  
Instrumentation



Simplicity L/R  
Assistant's  
Instrumentation



# Unit Options



UTILITY SERVICE CENTERS	Part Number	Retail
Basic USC	3625-722	N/C
Flush Mount USC	3625-597	\$866
NuSimplicity Contoured USC	3625-836	N/C
CORE Contoured USC	3625-936	N/C

LIGHT & MONITOR POSTS (PRETUBED OR NON PRETUBED CHAIRS)		
Light Post	3625-817	\$646
Light/Monitor Post	3625-818	\$1,670
LCD Monitor Mount	3625-615	\$1,423

FIBER OPTIC CONTROLS		
StarBright® Single FO System <i>(includes power supply &amp; handpiece tubings)</i>	3625-899X1	\$935
StarBright Dual FO System <i>(includes power supply &amp; handpiece tubings)</i>	3625-899X2	\$1,381
StarBright Triple FO System <i>(includes power supply &amp; handpiece tubings)</i>	3625-899X3	\$1,832

TOUCH PAD OPTIONS	Part Number	
CORE Unit Touchpad for CORE Chair	3655-362	\$693
CORE Unit Touchpad for NuSimplicity Chair	3655-363	\$693
Galaxy Unit Touchpad for CORE Chair	3655-373	\$457
Galaxy Unit Touchpad for NuSimplicity Chair	3655-321	\$478

HANDPIECE CONTROL OPTIONS		
4th Handpiece Control <i>(for CORE Delivery Unit)</i>	3680-428	\$628
4th Handpiece Control <i>(for Galaxy Delivery Unit)</i>	3680-338	\$593

Magellan Options continue on next page →

# Magellan Mount Options Continued

INTEGRATED PRODUCTS*	CORE	Galaxy
Integrated StarETorque	3680-441 \$6,143	3680-438 \$6,143

POWER SUPPLIES	Part Number	Retail
36V Power Supply	3625-762	\$709

ACCESSORIES		
Water Outlet with flow control and Air Quick Disconnect for NuSimplicity Chair <i>(includes bracket, tubing and mounting)</i>	3680-417	\$394
Water Outlet with flow control for Air Quick Disconnect for CORE Chair <i>(includes bracket, tubing and mounting)</i>	3680-437	\$278
Additional HVE valve and tubing	3625-536	\$152
City Water Kit	3658-485PI	\$483
City Water Kit for units with cuspidor	3658-484PI	\$103
Extra Length Umbilical <i>(specify number of feet not to exceed 10')</i>	3950-684	\$65 per ft.

**NOTES:** \*These integrated products must be included when ordering any delivery system, they cannot be field installed.  
\*\*Tips are not included.

# CORE™ Fixed Mount Unit Specifications

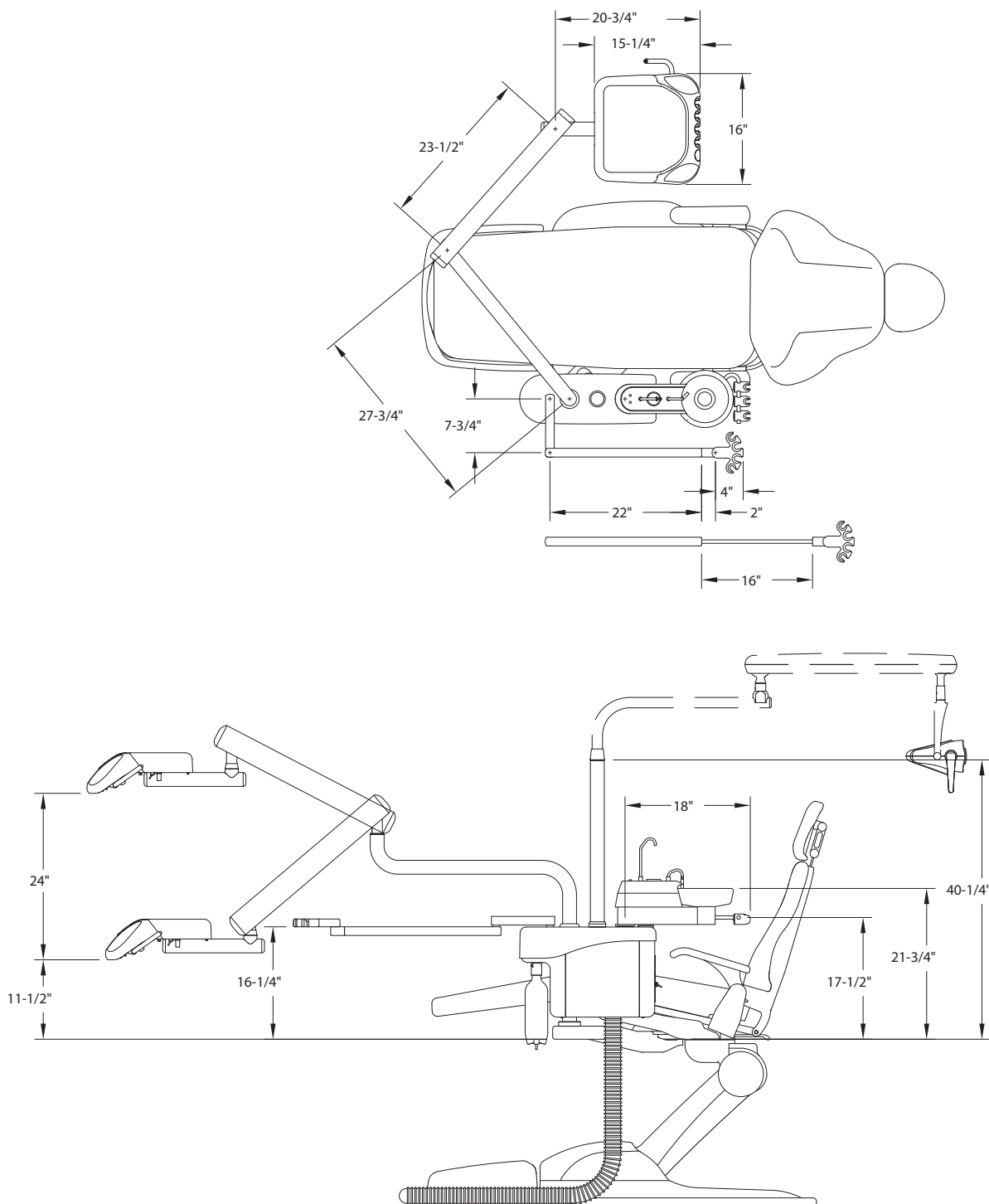

Delivery Units

# CORE™ Magellan Unit Specifications

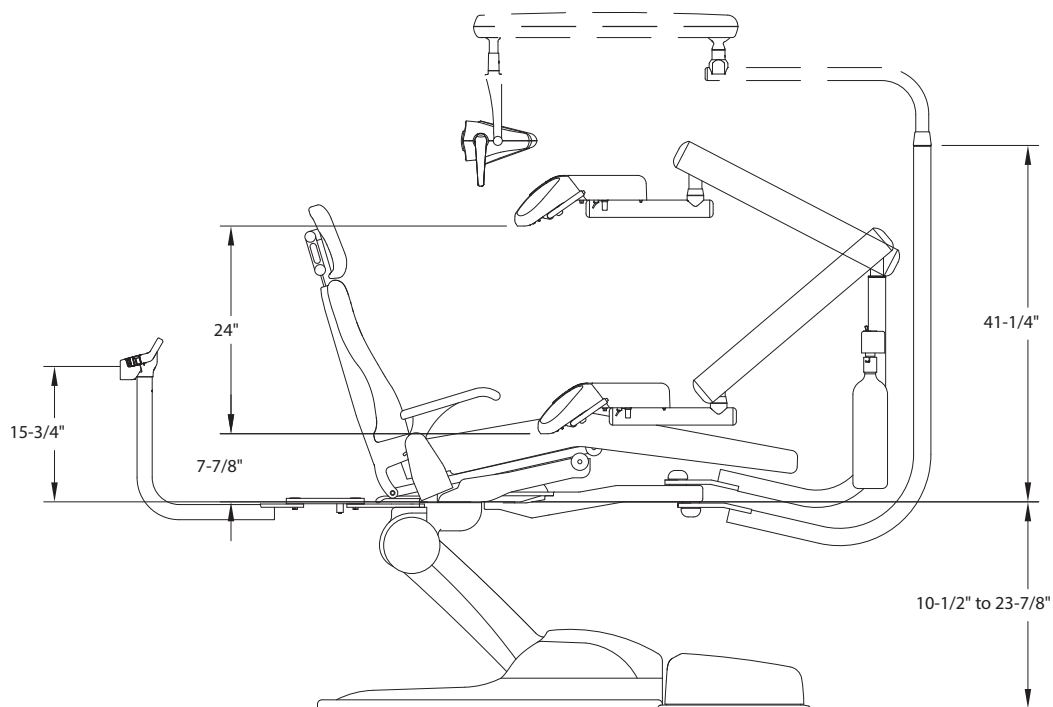
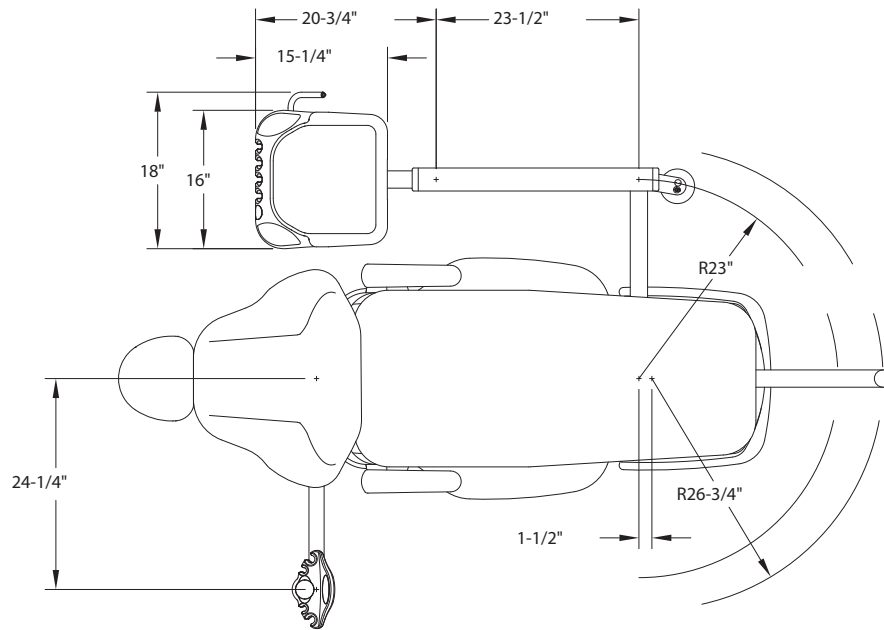

# Galaxy<sup>®</sup> Fixed Mount Unit Specifications

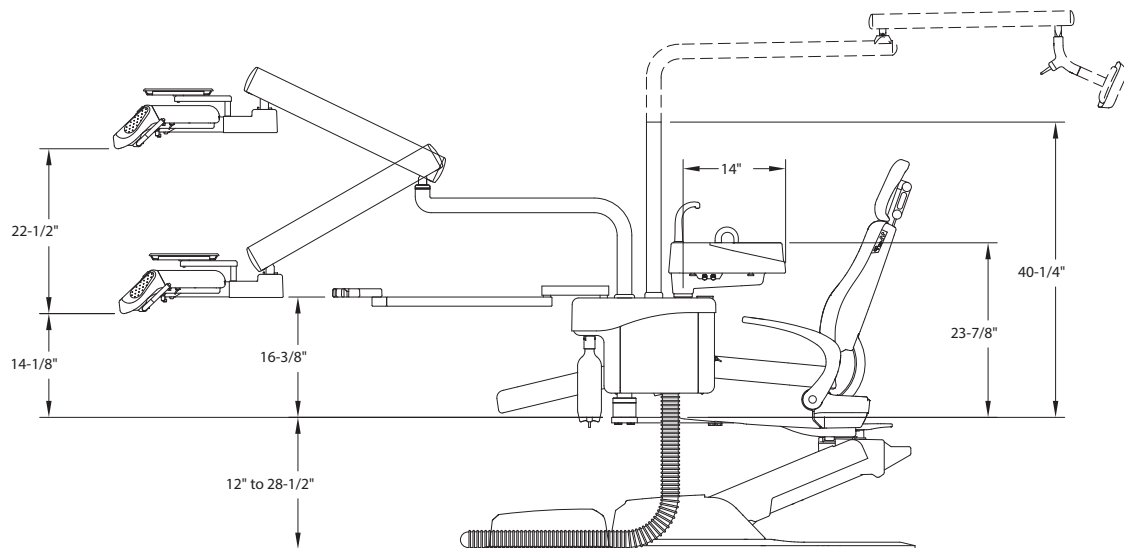
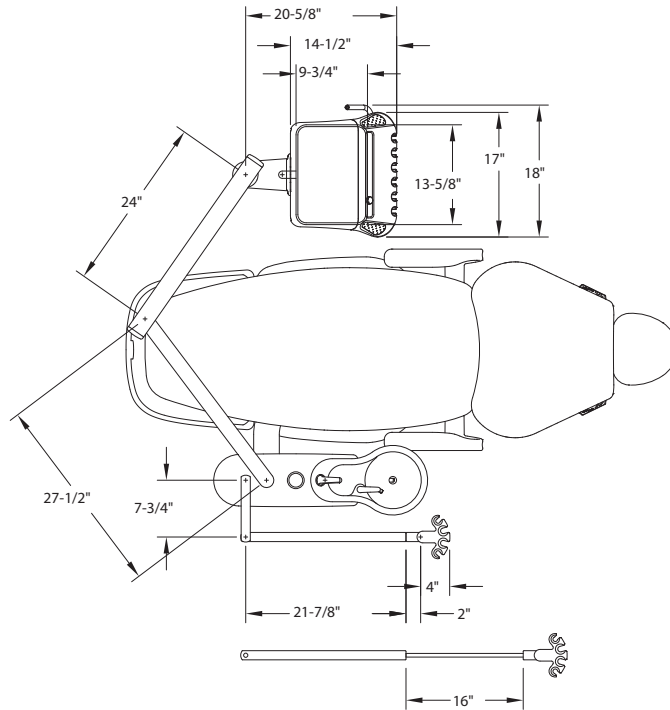

# Galaxy<sup>®</sup> Magellan Unit Specifications

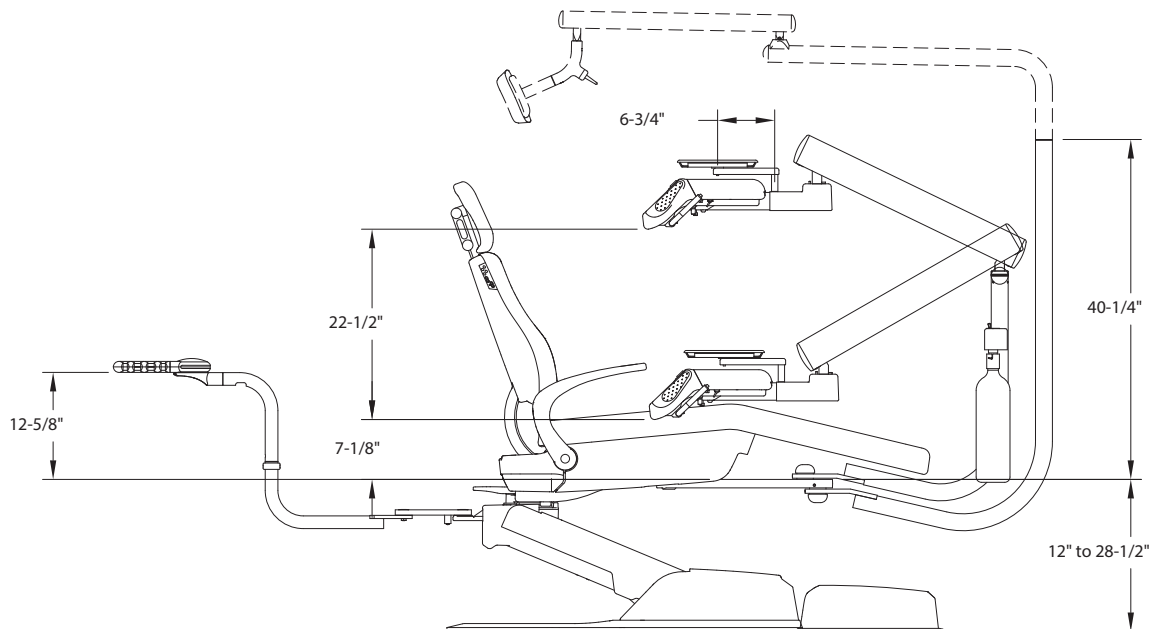
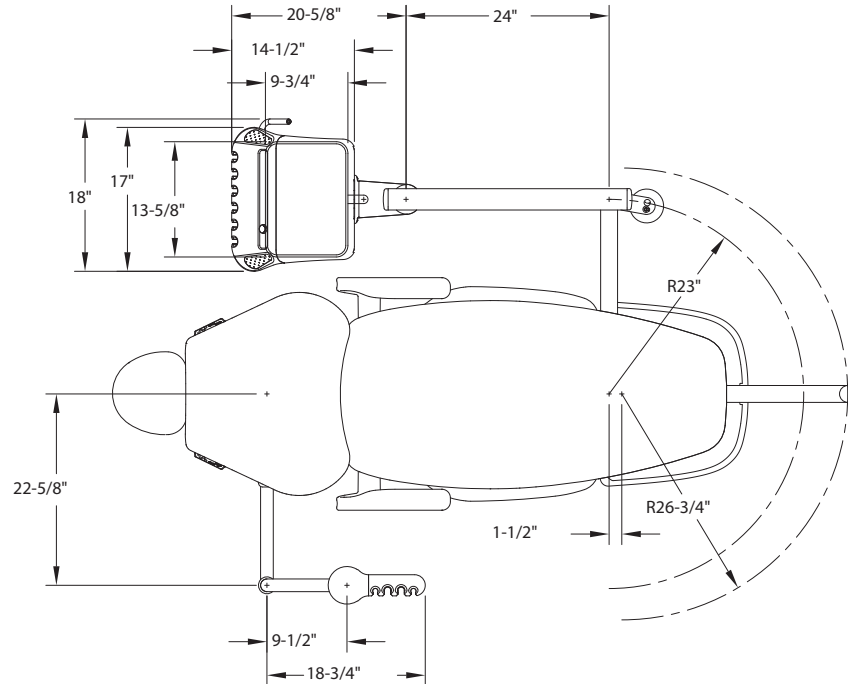

Delivery Units



DENTALEZ *HERITAGE*

# Lights



# Simplicity™ LED Light

Smooth rotation and 3 axis adjustment allow for a wide range of light positioning to better view the oral cavity.



Upgrade from  
Simplicity  
Halogen  
to LED

## Ordering Information

### Simplicity LED

	Part Number	Retail
Upgrade Kit from Simplicity Halogen	3802-581	\$2,084
Fixed Mounted Unit ( <i>light posts and part numbers can be found in Delivery Unit Section</i> )	3544-234	\$3,176
Ceiling Mounted 8'	3544-238	\$3,486
Ceiling Mounted 8'6"-10'	3544-237	\$3,486
Wall Mounted	3544-239	\$3,785
Cabinet Mounted without Mounting Kit	3544-240	\$3,533
Single Cabinet Mounting Kit	3625-714	\$289
Track Mounted 8'	3544-241	\$5,061
Track Mounted 8'6"-10'	3544-242	\$5,156
Track Mounted Dual Heads/Trolley 8'	3544-243	\$8,684
Track Mounted Dual Heads/Trolley 8'6"-10'	3544-244	\$8,684

### POSTS

Used to mount light on fixed mounted unit ( <i>Simplicity lights, EverLight</i> )	3625-710	\$247
Used to mount Magellan light post only on NuSimplicity	3625-814	\$1,617
Used to mount Magellan light post only on CORE chair	3625-950	\$1,444
Used to mount Magellan light post only on NuSimplicity with power adaptor included ( <i>includes chair mount, light post &amp; harness</i> )	3625-863	\$1,638
47.5" post to mount light only on NuSimplicity with NuSimplicity power adaptor included ( <i>requires 2" hub adaptor</i> )	3625-864	\$399
47.5" Light Post without bushing	3625-947	\$303
2" HUB Adaptor ( <i>for CORE Chair</i> )	3625-935	\$651
2" HUB Adaptor ( <i>for NuSimplicity Chair</i> )	3625-813	\$740

# Simplicity LED Light Specifications

- Kelvin Color Temperature: 5000 - 5700
- Light Pattern: 6.5" x 3.5"
- Maximum Light Intensity: 3345 Footcandles
- Minimum Light Intensity: 1672 Footcandles

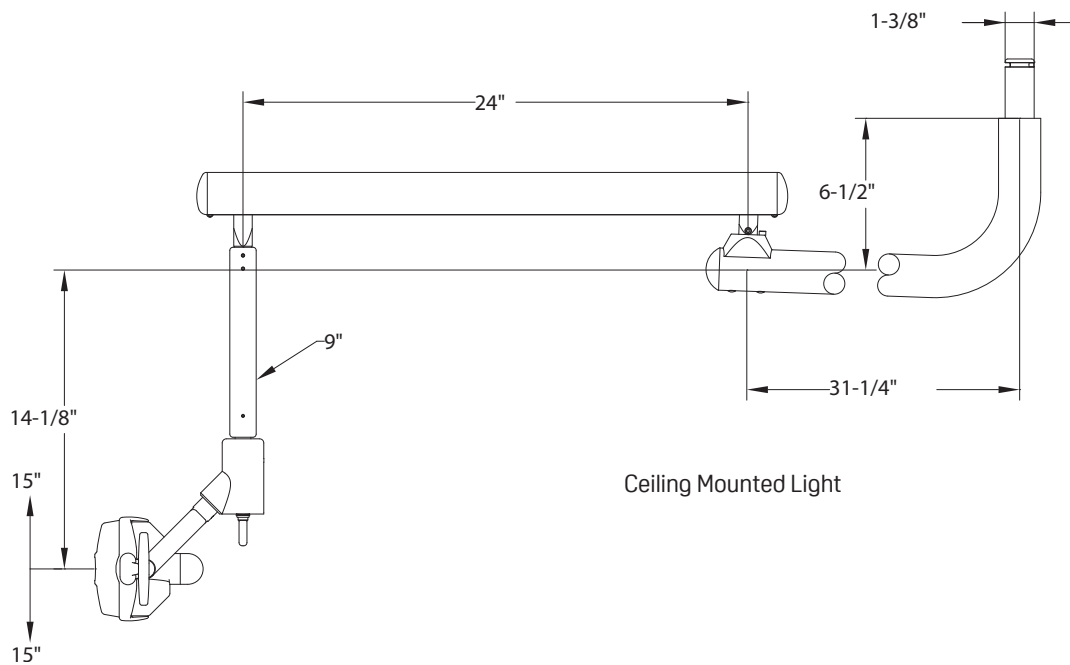
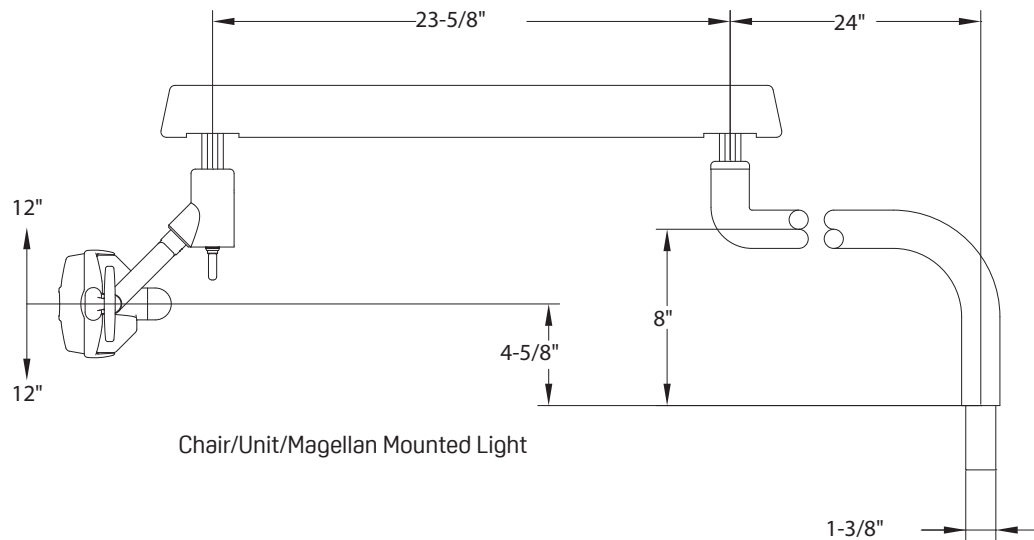

# Simplicity LED Light Specifications

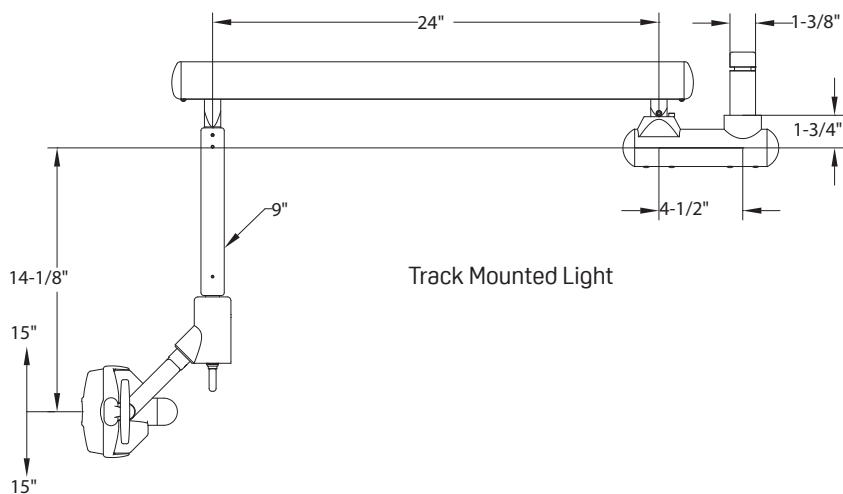

Track Mounted Light

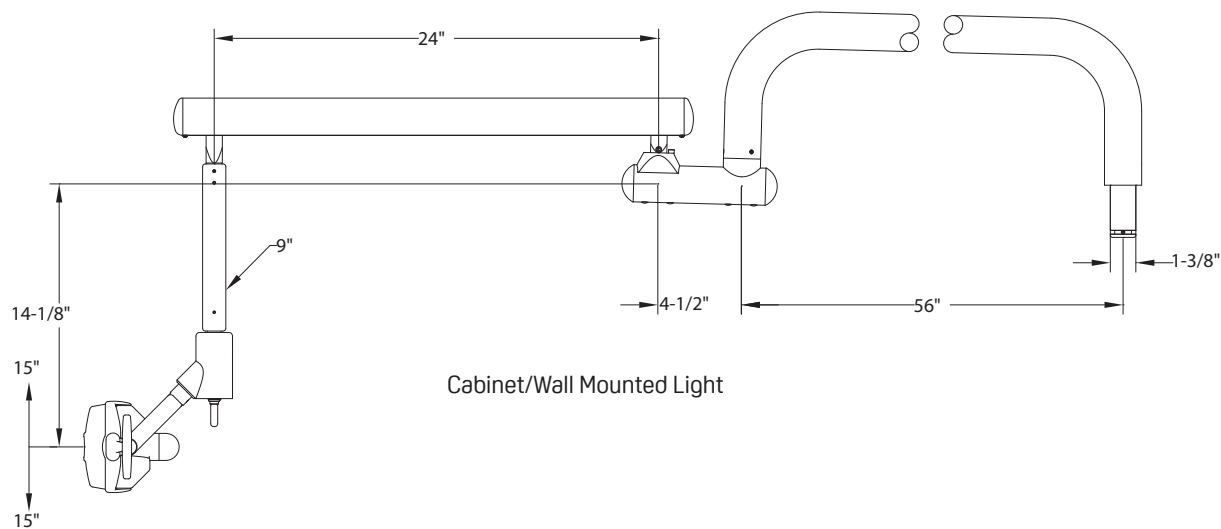

Cabinet/Wall Mounted Light

# Simplicity™ Halogen

Illuminates the oral cavity with minimal shadows.



## Ordering Information

Simplicity	Part Number	Retail
Simplicity Light, 115V Unit Mt w/transformer	3544-178	\$2,882
Simplicity Light, Unit - no transformer	3544-177	\$2,777
Simplicity 115V Ceiling Mount Light, 8'6" to 10'	3544-187	\$4,636
Simplicity Ceiling Mount Light, 115V, 8'	3544-217	\$4,730
Simplicity 120V Wall Mounted	3544-207	\$4,510
Simplicity 120V Cabinet Mount Light <i>(w/o Mount or post)</i>	3544-189	\$4,510
Simplicity Track Mounted 8' 120V	3544-191	\$5,786
Simplicity Track Mounted 8'6" to 10' 120V	3544-192	\$6,584
Simplicity Dual head Track Mount Light - 8' 120V	3544-215	\$10,542
Simplicity Dual head Track Mount Light - 8'6" to 10' 120V	3544-216	\$10,542
OPTIONAL ITEMS	Part Number	
Replacement Bulb	3801-797	\$32
Single cabinet mounting kit	3625-714	\$289
POSTS		
Used to mount light on fixed mounted unit <i>(Simplicity lights, EverLight)</i>	3625-710	\$247
Used to mount Magellan light post only on NuSimplicity	3625-814	\$1,617
Used to mount Magellan light post only on CORE chair	3625-950	\$1,444
Used to mount Magellan light post only on NuSimplicity with power adaptor included <i>(includes chair mount, light post &amp; harness)</i>	3625-863	\$1,638
47.5" post to mount light only on NuSimplicity with NuSimplicity power adaptor included <i>(requires 2" hub adaptor)</i>	3625-864	\$399
47.5" Light Post without bushing	3625-947	\$303
2" HUB Adaptor <i>(for CORE Chair)</i>	3625-935	\$651
2" HUB Adaptor <i>(for NuSimplicity Chair)</i>	3625-813	\$740

# Simplicity Halogen Light Specifications

- Kelvin Color Temperature: 4200 - 5500
- Light Pattern: 3.25" x 6.5" @ 28"
- Maximum Light Intensity: 3275 Footcandles
- Minimum Light Intensity: 1650 Footcandles

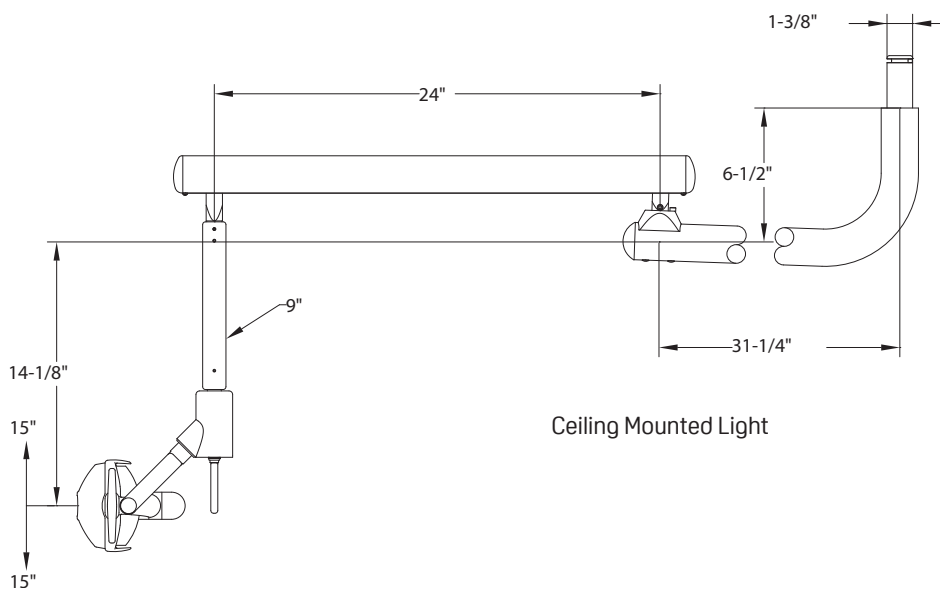
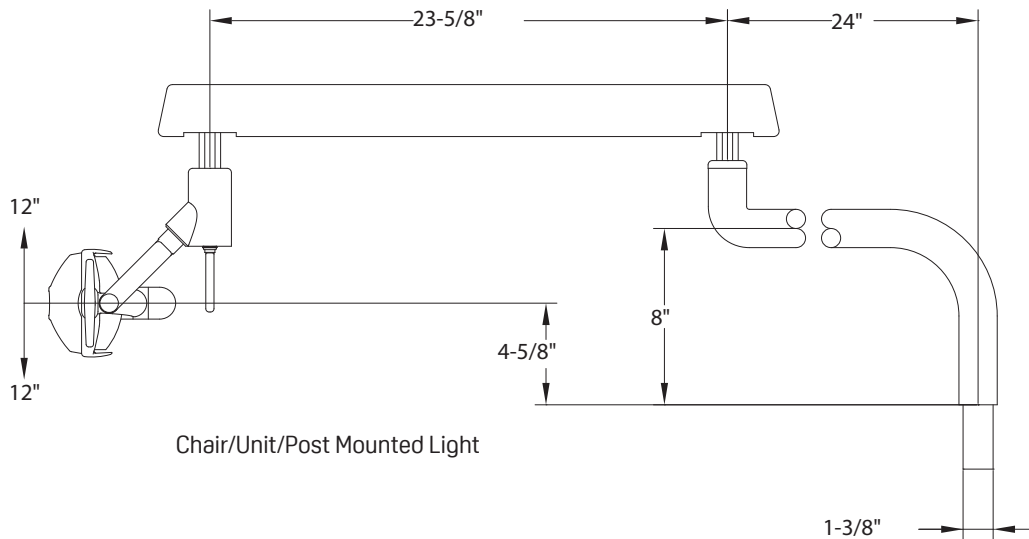



# Simplicity Halogen Light Specifications

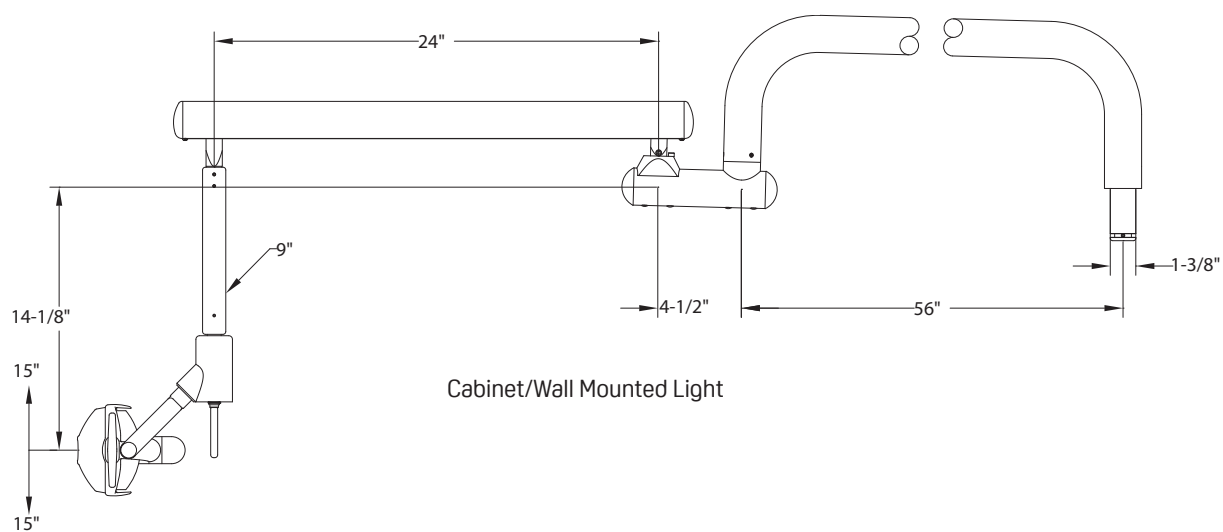
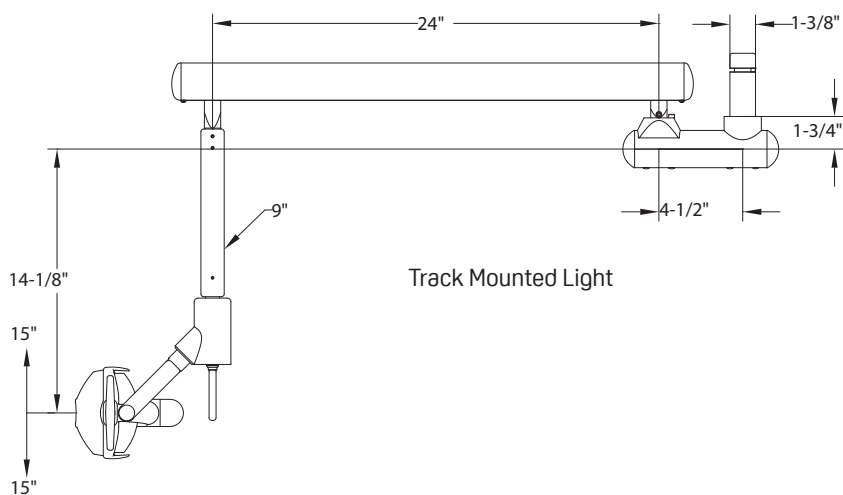

DentalEZ and its employees are proud of the products we provide to the dental community. We stand behind these products with a warranty against defects in material and workmanship as provided below.

In the event that you experience difficulty with the application or operation of any of our products, please contact our technical service department at our expense at (866)DTE-INFO.

If we cannot resolve the issue by telephone, we will arrange for a representative to contact you or suggest that the product be repaired by a dealer service technician.

If product repair or return is required, we will provide you with a **Return Authorization** number and shipping instructions to return the product to the proper facility. If the product is under warranty we will ask you to provide proof of purchase such as a copy of your invoice. Please be sure to include the **Return Authorization** number on the package you are returning. **Products returned without a return authorization number cannot be repaired.**

Freight costs for product returns are the responsibility of the customer. Products under warranty will be repaired or replaced, at our sole discretion, and returned at our expense. Products outside the warranty limits will be repaired and returned with costs invoiced to the customer. We are not responsible for shipping damages. We will, however, help you file a claim with the freight carrier. Written repair estimates are available.

DentalEZ warrants all equipment and parts to be free of defects in material and workmanship, under normal usage, under the following terms:

DentalEZ Heritage	Limited Warranty Period*
CORE Chair	5 Years from date of installation
NuSimplicity Chair	6 Years from date of installation
Stools	2 Years from date of installation
Chair/Stool Upholstery	1 Year from date of installation
Elbow Support	1 Year from date of installation
CORE Delivery Unit	5 Years from date of installation
Galaxy Delivery Unit (excludes tubings, wirings, fittings and syringe)	3 Years from date of installation
Simplicity LED	5 Years from date of installation
Simplicity Halogen	3 Years from date of installation
CORE Light	5 Years from date of installation
Sopro Camera, Piezo Scaler & Curing Light	1 Year from date of installation

Please note the following additional terms of our warranty and return policy:

- This warranty covers manufacturing defects only and does not cover defects resulting from abuse, accidents, misuse, improper handling, cleaning, care or maintenance. Damage resulting from the use of chemicals, cleaners, disinfectants or sterilization is not covered under this warranty nor is normal wear and tear. Failure to follow or observe our operating/use, maintenance and/or installation instructions voids this warranty as does the use of non-authorized parts and repairs made by an unauthorized repair facility.
- **Liability is limited to repair or replacement of the defective part(s) or products at our sole discretion. All other liabilities, in particular liability for damages, including, without limitation, special, exemplary, consequential or incidental damages are excluded.**
- THIS WARRANTY IS IN LIEU OF ALL OTHER WARRANTIES, EXPRESSED OR IMPLIED, INCLUDING ANY IMPLIED WARRANTIES OF MERCHANTABILITY OR FITNESS FOR A PARTICULAR PURPOSE. NO EMPLOYEE, REPRESENTATIVE OR DEALER IS AUTHORIZED TO CHANGE THIS WARRANTY IN ANY WAY OR TO GRANT ANY OTHER WARRANTY.

#### WARRANTY REPAIRS:

Parts repaired or replaced on a product that is in warranty will be warranted for the duration of that product's original warranty.

**PRODUCT RETURN:** Opened products or product returns more than a year old cannot be returned for credit. There will be a 15% (\$25.00 minimum) restocking charge on all items authorized for return.

#### NOTES:

\*See individual Product Manuals for complete warranty details. Provided conditions defined in instruction manual are met.

DentalEZ, EverLight, Galaxy, NextGen, and StarBright, are registered trademarks and Core, Generation, Simplicity, and NuSimplicity are trademarks of DentalEZ Inc.

*DENTALEZ CORPORATE*

301 Lindenwood Drive, Ste.100  
Malvern, PA 19355

T: 800.293.5206

F: 610.725.9894

*DENTALEZ.COM*

For all orders and/or questions please call our  
Customer Experience Representatives at 866.DTE.INFO.

2024 DENTALEZ, Inc. All rights reserved. DENTALEZ, Star and Dentoform  
are registered trademarks and Nevin is a trademark of DENTALEZ INC.  
Ramvac is a registered trademark of Ramvac Dental Products Inc.