

TITAN 5 STAR
Star
LUBRICATED PROPHY ANGLE

NON-STERILE
Rx ONLY
MD

DENTALEZ

DENTALEZ, Inc., StarDental Division
1816 Colonial Village Lane
Lancaster, PA 17601 USA

068962 Rev.U Date of Issue: 2022-11-01 ©2022 DENTALEZ, Inc.

DO NOT USE FOR ORAL SURGERY

Before operating the handpiece, carefully read and follow all of these instructions. Save these instructions for future reference and observe all warnings and cautions.

INDICATIONS FOR USE

Used intraorally by trained dental professionals for drilling and preparation of dental cavities for restoration, such as fillings, disking, cavity and crown preps, polishing, post and pin drilling and pin setting.

Rx ONLY Caution: U.S. Federal law restricts this device to sale by or on the order of a licensed physician.

WARNING Under normal operating conditions, air is exhausted from the back of the head of this handpiece. If air is directed into an open soft tissue wound or beneath the mucosa or dermis, injury to the patient could result from air embolism of air embolism.

WARNING This angle has no internal air or water cooling capabilities. External water for cooling may be required.

CONTENTS

- FEATURES
- INSTALLATION AND OPERATION
- SAFETY
- LUBRICATING
- CLEANING AND STERILIZATION
- TROUBLESHOOTING
- CARTRIDGE REPLACEMENT
- REPLACEMENT PART NUMBERS
- WARRANTY

FEATURES

Rated for use with Star Motors and Attachments
Titan Five Star Propy Angle:
Star Titan 3 Part #265803
Controlled Speed Reduces Propy Paste 'Spin-off'
Field Replaceable Cartridge
Quick, Easy Cleaning
Compatible with Titan 3 and Titan T Systems
Steam Sterilization: 135° C



Motor	Accessories	Ratio	Max Allowable RPM
5K	MTA	1:1	5,000
20K	Torque Multiplier & MTA	4:1	5,000

INSTALLATION AND OPERATION

PROPHY ANGLE INSTALLATION FOR TITAN 3 OR TITAN T SYSTEMS

- For the Titan 3 or Titan T systems thread angle onto motor-to-angle adapter (FIG. 1), Star Titan 3 Part #264073 or Titan T Part #263970, by hand. Seat completely.

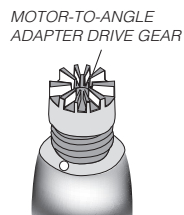

FIG. 1

CAUTION When angle does not seat on adapter, gears are not meshed correctly. Remove angle; spin motor-to-angle adapter drive gear and repeat step one.

- Fit angle disconnect wrench (FIG. 2), Star Part #203048, furnished with every angle, to mating indentations on angle neck; tighten securely.

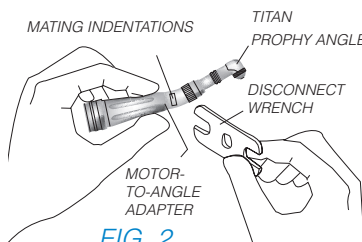

FIG. 2

PROPHY CUP INSTALLATION

The propy angle uses either a screw-on or a snap-on type polishing cup. When using a snap-on type cup, use the screw-to-button adapter, Star Part #258950. Thread the screw-to-button adapter (FIG. 3), or polishing cup, with a clockwise rotation until snug into the hollow cartridge shaft of the propy angle.

CAUTION Operate the Titan motor in the forward direction only. If the Titan motor is operated in reverse direction, the propy cup will separate from the motor.



FIG. 3

PROPHY CUP REMOVAL

Unthread the adapter, or polishing cup, counterclockwise. If the screw-to-button adapter is difficult to disengage, remove the propy cup, and use a small screwdriver to loosen the screw-to-button adapter.

SAFETY INSTRUCTIONS

PLEASE OBSERVE SAFETY INSTRUCTIONS

Before use, verify concentric rotation by operating the handpiece outside the oral cavity in a safe place.

LUBRICATING

- Lubricate with DentaLube II, Star Part #262539 once a day or before each sterilization procedure.
- Remove propy cup.
- Place a drop of DentaLube II down the center of the hollow cartridge shaft (allow a few seconds for the lubricant to drain down the shaft). (See FIG. 4)
- Place a drop of DentaLube II at the base of the angle. Allow a few seconds for the lubricant to drain and reach the bronze bushing. (See FIG. 5)

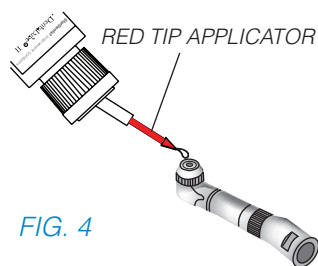

FIG. 4

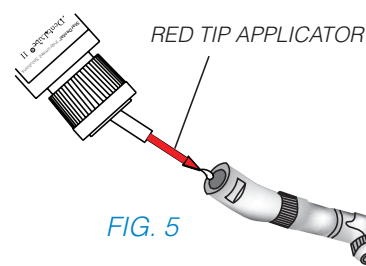
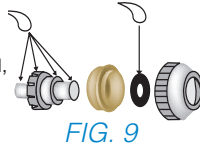

FIG. 5

CLEANING AND STERILIZATION

CAUTION	It is the responsibility of the user to use only FDA compliant sterilizing equipment and accessories that are capable of meeting the manufacturers recommendations below.
CAUTION	Do not exceed 135°C Do not use: <ul style="list-style-type: none"> • dry heat sterilizer • immersion techniques • detergents • chemical disinfectors • cold sterilizers • sterilizer bags containing disinfectants • surface wipes • hand soaps • ultrasonic cleaners • surface sprays • surgical milk
LIMITS ON REPROCESSING	Repeated processing has minimal effect on these Adapters. End of life is normally determined by wear and damage due to use.
INSTRUCTIONS	
WARNING	The angle must be cleaned and sterilized before first use and after each patient use.
CONTAINMENT AND TRANSPORTATION:	It is recommended that angles are reprocessed as soon as is reasonably practical following use.
PREPARATION FOR CLEANING:	Wear puncture resistant gloves to prepare the propy angle for sterilization. Remove propy cup or screw-to-button adapter from propy angle. Remove angel from motor-to-angle adaptor.
CLEANING AUTOMATED:	Washer-disinfectors are not recommended.
CLEANING MANUAL:	<ol style="list-style-type: none"> Clean and inspect once a day. Clean all external surfaces (FIG.6) with isopropyl alcohol and a lint-free cloth or brush. Use the plastic wrench to unthread the end cap by turning clockwise. (See FIG.7): Remove the cartridge and inspect as follows: If propy paste is not found on the cartridge, internal cleaning is not necessary. Simply wipe off with lint-free cloth. If propy paste is found on the cartridge, clean off the paste manually. The gear assembly and end cap may be ultrasonically cleaned (FIG.8).
	<p>Old Style: -No Markings on End Cap -Unthread End Cap in CounterClockwise Direction</p> <p>New Style: -C, L and L Marked On End Cap -Unthread End Cap in Clockwise Direction</p> <p>FIG. 6</p>
	<p>UNTHREAD END CAP IN CLOCKWISE DIRECTION</p> <p>PLASTIC WRENCH</p> <p>FIG. 7</p>
	<p>CARTRIDGE</p> <p>HOUSING</p> <p>GEAR ASSEMBLY</p> <p>BRONZE BUSHING</p> <p>O-RING</p> <p>END CAP</p> <p>FIG. 8</p>
NOTICE	Do not ultrasonically clean any other components.

CLEANING MANUAL CONTINUED:	7. When prophy paste is consistently found in the cartridge, install a new bronze bushing, or a new cartridge, Star Part #258948, which includes the bronze bushing. Replacing the bronze bushing renews the seal and protects the gear and bearing from abrasive paste.
	8. Wipe the inside of the housing with a lint-free cloth or cotton swab. Note: Do not immerse head in solvent.
	9. After cleaning, apply one drop of DentaLube II, Star Part #262539, to the inside diameter of the O-ring and to the gear as shown. (See FIG. 9)
	10. To reassemble, insert gear assembly into bronze bushing and guide shaft through the hole in O-ring. Install cartridge into prophy head angle.
	11. Turn end cap counterclockwise and hand tighten to secure. Use wrench to fully seat – 30° rotation maximum.
NOTICE	Do not overtighten as poor performance and damage to angle may result
LUBRICATION:	Lubricate - See 'Lubrication' instruction section.
DISINFECTION:	Use steam sterilization exclusively for complete sterility as outlined below.
MAINTENANCE:	Angle should be routinely maintained, checked for corrosion, worn parts, etc. and should be replaced on an as needed basis.
INSPECTION & FUNCTION TESTING:	See Installation, Operating Recommendations, and/or Troubleshooting sections of this manual.
PACKAGING:	Single: A standard sterilization packaging material must be used. Ensure that the pack is large enough to contain the item without stressing the seals.
WRAPPED INSTRUMENT STERILIZATION:	Gravity Type Autoclave: Pre-Vacuum Autoclave: • Minimum of 15 minutes at 132° C • Minimum of 4 minutes at 132° C • Minimum of 30 minutes at 121° C Do not exceed 135° C
DRYING:	Dry the prophy angle for 30 minutes minimum using the sterilization dry cycle and allow the prophy angle to cool to room temperature in bag prior to use. If moisture is present, increase your sterilizer dry cycle appropriately.
STORAGE:	Store in bag after sterilization until ready to use.
ADDITIONAL INFORMATION:	Do not exceed the sterilizer manufacturer's guidelines for load capacity. Use only paper or paper/plastic bags.
MANUFACTURER CONTACT:	See first or last panels of this manual.



CARTRIDGE REPLACEMENT

1. Remove the end cap using the plastic wrench to turn it clockwise. (See illustration under Cleaning and Lubricating.)

Note: Do not use pliers on the bronze bushing.

2. Pull bronze bushing to remove cartridge from prophy head as shown below in (FIG. 10). If cartridge is not removable by hand, thread a prophy cup or a screw-to-button adapter in the cartridge and tug on it.

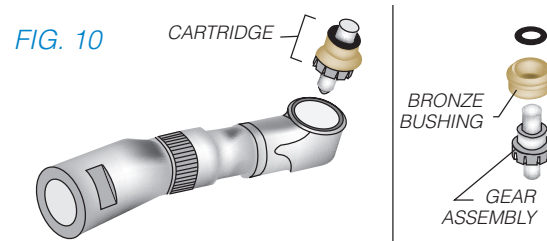

3. Separate gear assembly from the bronze bushing by pulling apart as shown above.
 4. If gears are worn, replace cartridge, Star Part #258948. If not, simply wipe clean with a lint free cloth.
 5. Wipe the inside of the housing with a lint free cloth or cotton swab, barely dampened with solvent.
- Note: Do not immerse head in solvent.
6. Guide the shaft of the gear assembly through the center of the bronze bushing. Install the assembled cartridge into the angle housing.
 7. Position end cap and turn counterclockwise. Hand tighten to secure. Use wrench to fully seat – 30° maximum.

NOTICE Do not overtighten as poor performance and damage to angle may result.

REPLACEMENT PART NUMBERS

ALWAYS INSIST ON STAR PARTS FOR BEST PERFORMANCE.

DESCRIPTION	ITEM NUMBER
Titan 3 Five Star Prophy Angle Cartridge Lubricated (Includes cartridge and bronze bushing with O-ring)	258948
Transmission Gear Assembly Lubricated.....	259008
Prophy Angle End Caps (Package of 2) Lubricated.....	265805
Screw-to-Button Adapter	258950
Angle Disconnect Wrench.....	203048
O-Rings (Package of 3)	258951
DentaLube II.....	262539
Titan 3 Motor-to-Angle Adapter	264073
Titan T Motor-to-Angle Adapter	263970

IMPORTANT NOTICE ABOUT RETURNING PRODUCT TO DENTALEZ INC.

Anyone wishing to return any DENTALEZ Inc. product to a DENTALEZ facility MUST obtain the proper RETURN AUTHORIZATION NUMBER from the Customer Service Department. The RA Number must appear clearly marked on both the outside and inside of the returned product carton. When calling for a return authorization number you will be asked to provide the following information:

- | | |
|---|--|
| To Obtain A Return Authorization Number Call 1-866-DTE-INFO | 1. Product Name, Model Number or Part Number |
| | 2. Serial Number of Product |
| | 3. Dealer Return Purchase Order Number |
| | 4. Reason For Return |
| | 5. Copy of Invoice Showing Purchase |

Items will be evaluated. Return Authorization Number is not a guarantee for credit. Your cooperation with this procedure will help us expedite processing of any returns.

FOR NEW PRODUCTS, MANUALS AND TECHNICAL INFORMATION, CALL 1-866-DTE-INFO OR VISIT OUR WEB SITE @ WWW.DENTALEZ.COM

LIMITED WARRANTY

O-Rings and Seals are specifically excluded from this warranty.

DENTALEZ warrants the Titan Lubricated Five Star Prophy Angle to be free of defects in material and workmanship, under normal usage, under the following terms:

Star Products: Lubricated Five Star Prophy Angle	Warranty Period*: 3 Months from date of purchase
---	---

Please note the following additional terms of our warranty and return policy:

- Warranty covers manufacturing defects only and does not cover defects resulting from abuse, accidents, misuse, improper handling, cleaning, care or maintenance or the failure to follow or observe our operating/use, maintenance and/or installation instructions. Damage resulting from the use of chemicals, cleaners, disinfectants or sterilization is not covered under this warranty nor is normal wear and tear. Failure to use authorized parts or an authorized repair facility voids this warranty.
- Liability is limited to repair or replacement of the defective part(s) or products at our sole discretion. All other liabilities, in particular liability for damages, including, without limitation, special, exemplary, consequential or incidental damages are excluded
- THIS WARRANTY IS IN LIEU OF ALL OTHER WARRANTIES, EXPRESSED OR IMPLIED, INCLUDING ANY IMPLIED WARRANTIES OF MERCHANTABILITY OR FITNESS FOR A PARTICULAR PURPOSE. NO EMPLOYEE, REPRESENTATIVE OR DEALER IS AUTHORIZED TO CHANGE THIS WARRANTY IN ANY WAY OR TO GRANT ANY OTHER WARRANTY.

*Provided conditions in warranty are met.

WARRANTY REGISTRATION

Please visit the website below to register your Star product. This will ensure proper registration and prompt and accurate service should any of your purchases need evaluation or repair during the warranty period.

Star Products: WWW.DENTALEZ.com/warranty

TROUBLESHOOTING

PROBLEM: LOW POWER

- Cause: Air leak at motor
Correction: Replace gasket; refer to Titan Motor Instruction Manual.
- Cause: Debris build-up
Correction: Refer to Cleaning and Lubricating section.
- Cause: Faulty angle
Correction: Replace cartridge.

Note: If a problem persists, contact dealer for further assistance; or, contact Star technical service at: 1-866-DTE-INFO (1-866-383-4636)