

## Attachments

# Star® ETorque™

Attachments User Manual

- 1:1 Straight**
- 5:1 AL-L Auto Latch**
- 5:1 AL Auto Latch**
- 1:1 AL-L Auto Latch**
- 1:5 AC-L FG Autochuck**

Rx only



[www.dentalez.com](http://www.dentalez.com)

ETorque Attachments  
Copyright 2018 DentalEZ. All rights reserved.

065476 Rev B 2018-02-21

All trade mark referred to this manual are property of their respective owners.

Manufactured for:



**DentalEZ Inc.**

**StarDental® Division**

1816 Colonial Village Lane

Lancaster, PA 17601 U.S.A.

Phone: 717-291-1161

Internet: [www.dentalez.com](http://www.dentalez.com)













## Table of Contents

1	Important Information.....	4
	Applied Symbols.....	4
	Safety precautions.....	6
	General warnings.....	7
	Warnings for reprocessing (cleaning – disinfection – care – sterilization).....	8
	Indications for Use.....	9
2	Specifications.....	11
3	Reprocessing Methods.....	16
	Preparation at the location of use.....	16
	Cleaning.....	16
	Sterilization in accordance with ISO 17665.....	18
	Storage.....	21
4	Installation and Commissioning.....	22
	Cooling media supply.....	22
5	Operation.....	24
	Removing handpiece.....	25
	Inserting cutters or diamond burs.....	26
	Removing cutters or diamond burs.....	28
6	Maintenance and Repair.....	29
	Care products and maintenance systems.....	29
	Care with dental lubricant.....	30
	Collet care.....	30
7	Warranty.....	31





# 1 Important Information

Dear Customer,  
We hope that you enjoy using your new quality product. In order to ensure that you use the product correctly, efficiently and safely, please adhere to the following information.

## Applied Symbols

Appearing In the manual / on the product		On the packaging	
 <b>WARNING</b>	Indicates a hazardous situation that can lead to serious injury or death		Keep dry
 <b>CAUTION</b>	Indicates a hazardous situation that can lead to property damage or minor to moderate injury		Maximum stacking load
 <b>NOTICE</b>	Important Information		Temperature range
	Situation which can result in injury or danger to persons, when the instructions are not followed.		Humidity
	Important information for users and technicians		Quantity
	Instructions for disposal		

## 1 Important Information

Appearing In the manual / on the product		On the packaging	
	Steam-sterilizable up to 135 °C (275 °F)		
	Thermodisinfected		
	Manufacturer		
	Observe instructions for use		
	Follow instructions for use!		

Product subject to technical modifications and design deviations.

No retrofit warranty on existing devices.

The manufacturer does not accept any responsibility for damages caused by:

- external effects (poor quality of media, impact damage, cleaning and care with unsuitable products or faulty installation)
- use of wrong information
- unintended use
- improper repairs

# 1 Important Information

**NOTICE** Repair and maintenance, except for the activities described in these instructions for use, must only be performed by qualified professionals!

- Changes made by third parties render the approval null and void.
- Use original parts and spare parts only.

The guarantee becomes ineffective if defects or their consequences are caused by manipulation or modification of the product by the customer or third parties not authorized by DentalEZ.



Disposal of devices and accessories after use:

Based on EC directive (WEEE 2012/19/EU) on waste electrical and electronic equipment, this product is subject to the aforementioned directive and must be disposed of through special channels. Contact the manufacturer or dental supply shop for further information.

## Safety precautions



**WARNING** Risks when using handpieces with electrical micro-motors!

Electrical micro-motors generate significantly more energy than conventional air turbines and air motors. Due to the high torques and speeds, poorly serviced, damaged or misused handpieces may lead to overheating which could inflict severe burns on the patient.

**NOTICE** Please observe the following!

- ▶ Carefully follow the maintenance Instructions.
- ▶ Inspect the handpiece for external damage before each use.
- ▶ Run a test with the handpiece before each use. Especially pay attention to unusual overheating, conspicuous noises and vibrations.

## 1 Important Information

- ▶ If a handpiece is found to be faulty, its use must be discontinued immediately.
- ▶ Never lift cheeks or tongues with the handpiece.

The Star ETorque System and its Attachments can only be repaired by authorized DentalEZ technicians. Repairs or tampering by non-authorized technicians or vendors will void the original warranty.

### General warnings

#### **WARNING**

- ▶ Ensure that all of the rotation instruments used are in proper-functioning condition.
- ▶ Ensure that the handpiece is securely engaged with the motor coupling and that the rotation attachment is fastened correctly before starting the handpiece.
- ▶ Use a motor that is in a proper-functioning condition.
- ▶ Avoid using a handpiece that is unusually warm.
- ▶ It is recommended that appropriate protective gloves and goggles be worn when working with the handpiece and the rotation instruments.
- ▶ Use a rubber dam during patient procedures.
- ▶ During a long treatment period, clean and check the attachment every ten minutes.
- ▶ The handpiece may only be disassembled by an approved retailer or the manufacturer.



## 1 Important Information

- ▶ Do not press the push-button of the handpiece during operation.
- ▶ Adjust the rotational speed of the motor to the handpiece used.
- ▶ Do not use rotation instruments (cutter, burs) which are blunt, bent or damaged.
- ▶ Use 1:5 FG Autochuck handpieces exclusively with spray cooling.
- ▶ Should a problem arise with the handpiece, consult our customer service department.
- ▶ Discontinue using the handpiece in the event of damage, overheating, unusual operating noises, excessive vibrations, an excessive lateral run-out of the instrument or an inadequate fixation of the instrument. In order to prevent further damage, consult our customer service department or your local retailer of this product.
- ▶ Risk from optical eadiation. Do not look directly into the light source. LED radiation must not be directed into the eyes of persons.

### Warnings for reprocessing (cleaning – disinfection – care – sterilization)

#### WARNING

- ▶ Clean and sterilize the handpiece prior to the first use and after each patient operation and prior to disposal.
- ▶ Remove the rotation instruments (burs, files, burs) before reprocessing.
- ▶ Only use disinfecting cleaning products that are designed for disinfecting dental handpieces and contra-angles. Do not use setting cleaning agents.
- ▶ Adhere to the concentrations and immersion periods recommended by the manufacturer of the disinfection product.

## 1 Important Information

- ▶ Do not use vinegar to clean the spray heads.
- ▶ Open the sterilization pouches directly before use.
- ▶ Excessive use of the cleaning products (dental care spray, cleaning and disinfection products) may possibly lead to the permeation of these products into the motor and may impair its functionality. The instructions for care for the respective product must be observed.
- ▶ If the handpiece will not be used for a long period of time, clean it as per the instructions after its last use and store it in a dry location.
- ▶ Observe the national guidelines and provisions for the processing of medical products.

### Indications for Use

- The device is intended to be used for the following applications:
  - 1:5 Attachment / 1:1 Straight : The removal of decayed matter, cavity and crown preparations, the removal of fillings and surface finishing of tooth and restoration surfaces.
  - 1:1 Auto Latch / 5:1 Auto Latch with or without light : Cavity preparations, caries excavation, endodontics, surface finishing of tooth and restoration surfaces.

## 1 Important Information

This medical product:

- Is only intended for dental treatment in the area of dentistry.



**WARNING** Any form of misuse or change of the product is forbidden and may lead to potential dangers.

- Is a medical product intended for use according to the applicable national legal provisions.

According to these regulations this medical product must only be used for the described applications by professional technicians and under consideration of the following issues:

- applicable industrial safety regulations,
- applicable accident prevention measures and
- these instructions for use.

According to these regulations it is the user's responsibility:

- to use only faultless work equipment,
- to ensure the correct purpose of use,
- to protect the patient and others from danger and
- to avoid contamination by the product.

## 2 Specifications

	<b>1:5 Friction Grip Autochuck Part# 265471</b>	<b>1:1 Auto Latch Part# 265472</b>	<b>5:1 Auto Latch; 5:1 Auto Latch Part # 265475; Part # 265474</b>
Max. drive speed	40,000 min <sup>-1</sup>	40,000 min <sup>-1</sup>	40,000 min <sup>-1</sup>
Transmission	1 : 5	1 : 1	5 : 1
Labeling	Red dots	Blue dots	Green dots
Max. rotation speed	200,000 min <sup>-1</sup>	40,000 min <sup>-1</sup>	8,000 min <sup>-1</sup>
Lighting system	Glass light rod	Glass light rod (only 1 : 1 AL-L)	Glass light rod (only 5:1 AL-L)
Chuck	Push-button chuck	Push-button chuck	Push-button chuck
Classification as per 93/42/EEC	Class IIa	Class IIa	Class IIa
Connection of instruments	ISO 3964 / DIN 13940	ISO 3964 / DIN 13940	ISO 3964 / DIN 13940

## 2 Specifications

	<b>1:5 Friction Grip Autochuck Part# 265471</b>	<b>1:1 Auto Latch Part# 265472</b>	<b>5:1 Auto Latch; 5:1 Auto Latch Part # 265475; Part # 265474</b>
Tools	Carbide cutter diamond burs made of steel or carbide according to ISO 1797-1, type 3	Carbide cutter/diamond burs made of steel or carbide according to ISO 1797-1, type 1	Carbide cutter/diamond burs made of steel or carbide according to ISO 1797-1, type 1
- Shaft diameter	1.59 – 1.60 mm	2.334 – 2.350 mm	2.334 – 2.350 mm
- Max. total length	25 mm	34 mm	34 mm
- Shaft clamping length	min. 11 mm		
- Cutting edge diameter	max. 2 mm		
Air cooling	8 NI/min 2.5 bar (36.3 psi)	8 NI/min 2.5 bar (36.3 psi)	8 NI/min 2.5 bar (36.3 psi)
Spray air	1.8 NI/min 2.7 bar (39.2 psi)	1.8 NI/min 2.7 bar (39.2 psi)	1.8 NI/min 2.7 bar (39.2 psi)
Spray water	50 ml/min 2 bar (29 psi)	50 ml/min 2 bar (29 psi)	50 ml/min 2 bar (29 psi)

## 2 Specifications

	<b>1:1 Straight Part# 265473</b>
Max. drive speed	40,000 min <sup>-1</sup>
Transmission	1 : 1
Labeling	Blue ring
Max. rotation speed	40,000 min <sup>-1</sup>
Classification as per 93/42/EEC	Class IIa
Connection of instruments	ISO 3964 / DIN 13940

## 2 Specifications

	<b>1:1 Straight</b> <b>Part# 265473</b>
Tools	Handpiece burs/contra-angle burs made of steel or carbide according to ISO 1797-1, type 2 - Shaft diameter: 2.334 – 2.350 mm - With bur stop: Shaft clamping length min. 12 mm / max. 22 mm - Without bur stop: Shaft clamping length min. 30 mm / max. 44.5 mm
Air cooling	8 NI/min      2.5 bar (36.3 psi)
Spray air	1.8 NI/min    2.7 bar (39.2 psi)
Spray water	50 ml/min     2 bar (29 psi)

## 2 Specifications

### Ambient conditions

---

Installation location:	Permitted in interior rooms
Ambient temperature:	10 – 40 °C (50 – 104 °F)
Relative humidity:	30 – 75 %

### Storage and transport conditions

---

Ambient temperature:	Transport: -30 – 70 °C (-22 – 158 °F) Storage: 0 – 40 °C (32 – 104 °F)
Relative humidity:	15 – 93 %
Air pressure:	No restriction
Keep dry!	

Subject to technical changes.



### 3 Reprocessing Methods

In the following the reprocessing methods according to ISO 17664 are described.

#### Preparation at the location of use



#### **WARNING** Danger from non-sterile products!

Contaminated medical products pose a threat of infection.

- ▷ Take suitable action to protect personnel.
- ▷ Immediately remove residues of cement, composite or blood at the place of use.
- ▷ Transport the medical product in dry condition for reprocessing.
- ▷ Do not soak in solutions.
- ▷ The medical product must be reprocessed right after the treatment.

#### Cleaning

#### **NOTICE** Malfunctions by cleaning in ultrasonic device!

Defects of the medical product.

- ▷ The medical product must not be placed in a cleaning basin or ultrasonic device.

### 3 Reprocessing Methods

#### Option I

#### Manual exterior cleaning

Necessary accessories:

- Potable water 30 °C ± 5 °C (86 °F ± 9 °F)
- Brush, e.g., medium-hard toothbrush

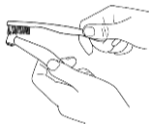

- ▶ Brush under running potable water for 20 seconds.

- ▶ Use dental lubricant spray in accordance with the instruction for use

#### Option II

#### Automated internal and external cleaning and disinfection in a washer-disinfector according to ISO 15883



#### **NOTICE** Wet medical product after reprocessing!

Defects with the use of wet medical product.

- ▷ Choose suitable cleaning and drying method.
- ▷ Ensure that the medical product is completely dry after reprocessing.



In some countries the applicable national guidelines require automated reprocessing in a validated washer-disinfector (WD). Observe instructions for use.

#### **Validated parameters for thermal disinfection**

Detergent:	TPH 5949 (S&M)
PH-Value:	max. 10
Program:	Thermal disinfection
Temperature:	≥ 93 °C
Exposure time:	≥ 5 minutes
Drying time:	≥ 15 minutes

## 3 Reprocessing Methods

### Option I

#### Automated interior cleaning and maintenance

- ▶ Use an automated cleaning and maintenance device in accordance with the instructions for use of the device.

#### Disinfection

The medical product can be disinfected in a steam sterilizer.

- ! ▶ Observe national and regional guidelines.

#### Sterilization in accordance with ISO 17665

#### Packaging

The packaging of sterile goods must be adapted to the instrument in order to have a tension-free packaging.

The packaging of sterile goods must fulfil the applicable standards regarding quality and use and must be suitable for the sterilization method!

- ▶ Package the medical products individually in packaging for sterile goods.
- ▶ Perform sterilization in a steam sterilizer (autoclave) in accordance with EN 13060 following ISO 17665-1.

### Option II

- ▷ Use only WDs with integrated drier.
- ▷ Select an appropriate program on the WD with drying cycle.
- ▷ Observe national guidelines.

#### Automated maintenance

- ▶ Use an automated maintenance device in accordance with the instructions for use.

### 3 Reprocessing Methods

**NOTICE** Premature wear and malfunctions by improper maintenance and care!

Reduced life span of the product.

▷ Treat medical product with dental cleaning products before each sterilization cycle.

**NOTICE** Contact corrosion caused by moisture!

Damage to the medical product.

▷ Immediately remove the medical product from the steam sterilizer after the cycle is complete.

The medical product can withstand a temperature of up to 138 °C (280.4 °F).

The medical product can be sterilized in steam sterilizers.

- ▶ Observe national and regional guidelines.
- ▶ Observe the instructions of the autoclave manufacturer.

**!** Sterilization in a standards-compliant (e.g. EN 13060) steam sterilizer with validated B or S cycle.

### 3 Reprocessing Methods

Recommended sterilization methods or parameters are as follows:

Pressure impulse method S cycle	134 °C (273.2 °F) Minimum pressure 300 kPa	Minimum sterilization time	3.5 - 5 - 18 minutes*	Minimum drying time	15 minutes
Vacuum method B cycle	134 °C (273.2 °F) Minimum pressure 300 kPa	Minimum sterilization time	3.5 - 5 - 18 minutes*	Minimum drying time	10 minutes

\* Depending on the type of use. National guidelines have to be observed.

- ▶ Follow the instructions of the autoclave manufacturer regarding the sterilization of this medical products for autoclaves with S cycle method.

Dynamic Air Removal: Wrapped or pouched	132 °C (270 °F)	Minimum sterilization time = 4 minutes	Drying time = 60 minutes
	134 °C (273 °F)	Minimum sterilization time = 3.5 minutes	Drying time = 60 minutes
	135 °C (275 °F)	Minimum sterilization time = 3 minutes	Drying time = 60 minutes

**NOTE! This table represents the variation in sterilizer manufacturers' recommendations for exposure at different temperatures!**

- ▷ For a specific sterilizer, consult only that manufacturer's recommendations.

### 3 Reprocessing Methods

#### Storage

- ▶ Store reprocessed products in a dust-protected, dry, dark and cool room which is as sterile as possible.



Please observe the use-by date of the sterile product!

## 4 Installation and Commissioning



### **WARNING** Risks posed by unsterilized products!

Risk of infection to user and patient.

- ▷ Before putting the device into operation for the first time and after each use, reprocess the medical product accordingly and sterilize if necessary.

### **NOTICE** Malfunction of the handpiece as a result of a low ambient temperature!

Possible malfunctions of the handpiece.

- ▷ Before putting into operation, return cooled products to a temperature of 20 – 25 °C (68 – 77 °F).

### **NOTICE** Damage may occur as a result of polluted and moist cooling air!

Polluted and moist cooling air may lead to malfunctions and premature bearing wear.

- ▷ Ensure that the cooling air is dry, clean and unpolluted as per ISO 7494-2 standards.

### Cooling media supply



### **CAUTION** Overheating of tooth as a result of a low volume of water!

Thermal damage of the pulp.

- ▷ Set water volume to at least 50 ml/min for the spray cooling.
- ▷ Inspect spray water channels and clean spray nozzles if necessary.

## 4 Installation and Commissioning



### **WARNING**

Dangers will result from damage, unusual operating noises, excessively strong vibrations, excessive heating or if the cutter or burs are not tightly fastened!

Dangers to the user and patient.

▷ Discontinue use and inform the service department.



### **WARNING**

**Risk of burns from the hot head or lid of the instrument!**

If the instrument overheats, burns may occur in the mouth area.

▷ Never touch soft tissue using the head or lid of the instrument.



### **CAUTION**

**Risk posed by an incorrectly stored instrument!**

Clamped cutters or burs may lead to injury or infection.

Damage to the chuck may occur if the instrument is dropped.

▷ Correctly return instrument to the tray without the cutter or burs after the treatment.

### **NOTICE**

**Premature wear and malfunctions may arise as a result of incorrect storage before long periods of non-use!**

Shorter product life cycle.

▷ Before long periods of non-use, the medical product should be cleaned according to the instructions, treated and stored in a dry location.



## 5 Operation

**⚠ WARNING** **The handpiece may become loose during treatment!**

An incorrectly-latched handpiece may detach from the motor coupling and fall down.

- ▷ Before each treatment, check whether the handpiece is securely latched with the motor coupling by gently pulling it.

**⚠ CAUTION** **Removing and returning the handpiece while the drive motor is rotating.**

Damage to the catch.

- ▷ Never remove or return the handpiece while the drive motor is rotating.

**⚠ WARNING** **When used together with a drive motor (1:1 Straight)!**

The handpiece may become blocked.

- ▷ Only use handpiece when the chuck is in a closed position.

**NOTICE** **Damage (1:5 AC-L FG/ 1:1 AL-L / 5:1 AL-L / 5:1 AL)!**

Pressing the foot switch while connecting and removing the handpiece may lead to damage to the handpiece and to the motor coupling.

- ▷ Do not connect or remove the handpiece while pressing the foot switch.

## 5 Operation

1. Slightly moisten O-Rings on the motor coupling using a dental lubricant.
2. Insert the handpiece in the motor coupling and rotate until the latch audibly engages.
3. Ensure that the handpiece is securely inserted in the coupling by pulling back on the motor.

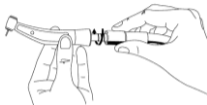

1:5 AC-L FG / 1:1 AL-L / 5:1 AL-L / 5:1 AL



1:1 Straight

### Removing handpiece

- ▶ Unlatch handpiece from motor coupling by rotating slightly and remove in the direction of the axis.

## 5 Operation

### Inserting cutters or diamond burs



Only use carbide cutters or diamond burs that meet the criteria specified under chapter 2 "Technical Data"!



**WARNING** Use of unauthorized cutters or burs!

This may cause injury to the patient or damage to the handpiece.

- ▷ Observe the instructions for use and only use cutters or burs according to the intended use.
- ▷ Only use cutters or burs which do not deviate from the specified data.



**WARNING** Risk of injury from cutters or burs!

Infections or cutting injuries.

- ▷ Wear protective gloves or finger guards.



**CAUTION** Injuries when using worn cutters or burs!

Cutters or burs could fall out and injure the patient during the treatment.

- ▷ Never use cutters or burs with worn shafts.

## 5 Operation



### **CAUTION** Risks posed by faulty chuck!

The cutter or burs could fall out and lead to injuries.

- ▷ When inspecting, inserting and removing, wear protective gloves or finger guards in order to prevent risk of injury or infection.
- ▷ Pull on the cutter or burs to check whether the chuck is functioning correctly and to ensure that the cutter or burs is in a fixed position.

How to use the handpieces: **1:5 AC-L FG / 1:1 AL-L / 5:1 AL-L / 5:1 AL**

1. Firmly press the push-button using your thumb and simultaneously insert the cutter or burs as far as it will go.
2. Ensure that the cutter or burs is in a fixed position by pulling it.
3. Ensure that the push-button lies evenly and is not tilted.



How to use the handpieces: **1:1 Straight**

1. Turn the clamping ring anti-clockwise and insert the cutter or burs into the chuck as far as it will go.
2. Re-tighten the clamping ring by turning it clockwise.
3. Ensure that the cutter or burs is in a fixed position by pulling it.

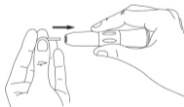

## 5 Operation

### Removing cutters or diamond burs



**CAUTION** Risk of injury from the rotating cutter or burs!

Cut injuries and damage to the chuck.

- ▷ Do not touch rotating cutters or burs.
- ▷ Never press the push-button while the cutter or burs is rotating.
- ▷ Remove cutter/ burs from the handpiece after the treatment has ended in order to prevent injury and infections when returning to the delivery unit.

How to use the handpieces: **1:5 AC-L FG / 1:1 AL-L / 5:1 AL-L / 5:1 AL**

- ▶ After the cutter or burs has been switched off, firmly press the push-button using your thumb and simultaneously pull the cutter or burs out.



How to use the handpieces: **1:1 Straight**

1. After the cutter or burs has been switched off, turn the clamping ring anti-clockwise and pull the cutter or burs out.
2. Re-tighten the clamping ring by turning it clockwise.

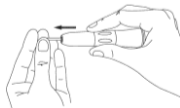

## 6 Maintenance and Repair

### **CAUTION** Risk of injuries and damage to material by improper maintenance!

- ▷ Have maintenance work only performed by an authorized dealer.
- ▷ Have the device sent to maintenance once a year after the guarantee period has elapsed or after 250 processing cycles.

To guarantee a flawless function of the medical product:

- ▶ Treat the medical product in accordance with the processing methods described in the instructions of use and use the care products and maintenance system described therein.
- ▶ Determine an internal maintenance interval for the practice, at which the medical product is evaluated by an authorized dealer in terms of cleaning, maintenance and function. This maintenance interval depends on the frequency of use and must be adapted accordingly.

### Care products and maintenance systems

### **CAUTION** Sharp milling cutter or burs in medical product!

Risk of injury by sharp and/or pointy milling cutter or burs.

- ▷ Remove milling cutter or burs.

### **NOTICE** Premature wear and malfunctions by improper maintenance and care!

Reduced life span of the product.

- ▷ Regularly perform proper maintenance.

## 6 Maintenance and Repair

### Care with dental lubricant

The medical product must be maintained after each cleaning and before each sterilization.

1. Remove milling cutter or burs.
2. Cover medical product with maintenance bag.
3. Place medical product on the cannula and activate spray button for one second.
4. Insert milling cutter or burs.
5. Operate handpiece to expel excess dental care spray.
6. Remove milling cutter or burs.



### Collet care

Perform collet care once a week.

- ▶ Remove milling cutter or burs and spray with the tip of the spray nozzle into the opening.



## 7 Warranty

### Limited Warranty

For a period of one year, **DentalEZ** guarantees that the **ETorque** attachments, when manufactured by **DentalEZ** in new and unused condition, will not fail during normal service due to defects in material and workmanship that are not due to apparent abuse, misuse, or accident. The one year warranty will cover the performance of all components of the attachments except consumables, provided that the product is being used and maintained according to the description in the operator's manual.

In the event of failure due to such defects during this period of time, the exclusive remedies shall be repair or replacement, at **DentalEZ**'s option and without charge, of any defected part(s) (except gaskets, seals, O-rings and couplings), provided **DentalEZ** is notified in writing within thirty (30) days of the date of such a failure and further provided that the defective part(s) are returned to **DentalEZ** prepaid. This warranty shall be considered to be validated, if the product is accompanied by the original purchase invoice from the authorized **DentalEZ** dealer, and such invoice identifies the item by serial number and clearly states the date of purchase. No other validation is acceptable.

After one year, all **DentalEZ** warranties and other duties with respect to the quality of the product shall be conclusively presumed to have been satisfied. All liability, therefore, terminate, and no action or breach of any such warranty or duty may thereafter be commenced against **DentalEZ**.

Any express warranty not provided hereon and any implied warranty or representation as to performance, and any remedy for breach of contract which, but for this provision, might arise by implication, operation of law, custom of trade or course of dealing, including any implied warranty of merchantability or of fitness for particular purpose with respect to all and any products manufactured by **DentalEZ** is excluded and disclaimed by **DentalEZ**. If you would like to learn more about **DentalEZ** products and features, visit our website at [www.dentalez.com](http://www.dentalez.com).



